

JANUARY 2025

THE NORTH SHORE'S ULTIMATE
REAL ESTATE
GUIDE





RED PINE REALTY

LOCALLY OWNED AND OPERATED SINCE 1996

14 S. BROADWAY, GRAND MARAIS, MN | 218-387-9599



VISIT OUR OFFICE TO SPEAK WITH A REALTOR. HOURS: M-F 9AM-5PM, SAT 10AM-4PM

REALTORS*: Sue Nichols, Broker • Jake Patten, Associate Broker • Jess Smith • Melissa Gregg • Mike Raymond • Alice McFarlane, Admin.

NEW LISTING



LOON LAKE 130 ACRES

Stunning 130-acre expanse featuring nearly 4000 feet of shoreline. Located 40 miles from Grand Marais in the popular "Mid-Trail" area with access to lodges, restaurants and outfitters. Property has mixed zoning: Lakeshore Residential with a 1-acre minimum and Forest/Agriculture Residential, with a 5-acre minimum. Potential for development, splitting off some parcels or preserving as a private retreat

MLS#6117248 **\$1,400,000**

NEW LISTING



NORTHWOODS RETREAT ACREAGE

The beginnings of a Northwoods retreat or homestead are already here. 7.5 acres located just 5 miles from Grand Marais with year-round county maintained road access on the north and south property borders. Good building sites, with driveway, bunkhouse, storage sheds and electric set up for your campouts until you build.

MLS# 6117206 **\$155,000**

INLAND LAKE PROPERTIES

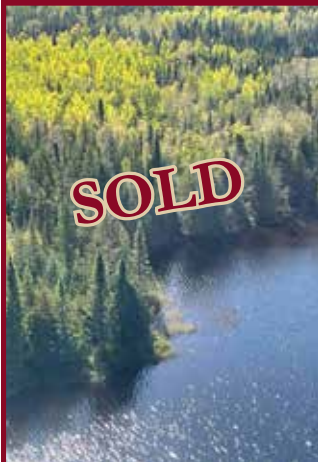

PRIME LAKE LOT - PORTAGE LAKE

Two acre lot, 361 feet of shoreline, driveway and site prep has begun, septic sites located. Lot adjoins federal land. High view looking down the lake. Portage Lake feels like the BWCAW, which is a portage away. Premier site waiting for great home or cabin.

MLS#6116511

\$249,000



CARRIAGE HOUSE/GARAGE - PORTAGE LAKE

Mid-Gunflint Trail lakeshore, 1 bedroom apartment above garage on 5.24 acres. Apartment is ready to move in. The 233 feet of shoreline is ready to launch your wilderness adventure. Portage Lake has direct access to the BWCAW by portage, good trout fishing, and no easy public access.

MLS#6116510 **\$285,000**



PEACE AND SERENITY - BWCAW-ADJACENT LOT

Large lot on Portage Lake, dense forest, rolling terrain and accessible shoreline for launching your wilderness adventures. 5.86 acre lot, over 500 feet of shoreline. Mid-Gunflint Trail location is remote and private. Your stress level will dissolve here, surrounded by the peaceful setting.

MLS#6116513 **\$239,000**



PORTAGE LAKE - MID-TRAIL LAKE LOT

Wilderness serenity surrounds you. Direct access to the BWCAW, or just enjoy it from your deck. 5.13 acre lot, 400 feet of accessible lakeshore, nice building sites amid typical boreal forest landscapes. Huge rock faced cliff guards a pond, deep forest and pristine lake views.

MLS#6116512

\$209,000



WILDERNESS PRIVACY LOG HOME - PORTAGE LAKE

Pristine 20 acres, 2500+ feet of Portage Lake shore, unique Mid-Gunflint Trail location. Surrounded by Superior National Forest & BWCA. Beautiful full-log home, 2 bedroom, 1 bath, porch, 2-car garage and gardens. Peninsula, privacy and views. Pristine location on quiet wilderness lake.

MLS#6115290

\$849,000

www.RedPineRealty.com • info@RedPineRealty.com



VISIT OUR OFFICE TO SPEAK WITH A REALTOR. BUSINESS HOURS: M-F 9AM-5PM, SAT 10AM-4PM



FEATURED LISTING

3 BEDROOM GRAND MARAIS HOME

Located in a quiet neighborhood and an enjoyable walk away from everything in Grand Marais! Three bedroom, 2 bathroom house has a newer roof and gutters. A brand-new deck and exterior stairs! Zoned Permanent Resident, so make this your own residence or rent it out long-term.

MLS#6114935 **\$275,000**



DEVELOPMENT OPPORTUNITY

SPECTACULAR LAKE SUPERIOR VIEWS

This could be the most impressive private land in Cook County. Situated 300 feet above Lake Superior, the views rival those at Pincushion Mountain. The 40 acres is surrounded by county & federal land with the Superior Hiking Trail running through the SE corner. Historically known as the Jagerhaus Bed & Breakfast. An opportunity to create something new after a fire in 2023. The foundation and other buildings remain. Visitors are required to be accompanied by licensed real estate agent.

MLS#6116536 **\$600,000**



FEATURED LISTING

LARGE HOME - SILVER BAY

Five bed, 2 bath home with plenty of room and comfortable spaces. Hardwood floors, fireplace, updated appliances and new mechanical systems. The large lower level has space for projects or rec-room. Large yard and extra garage.

MLS#6115564
\$307,900

INLAND LAKE PROPERTIES



GULL LAKE CABIN

Own a beautiful cabin on coveted Watters Point near the end of the Gunflint Trail with direct access to the BWCAW. Cabin sits on 1.7 acres on Gull Lake and features an open concept layout with a spacious loft area, a wood burning stove to take the chill out of the air and a 3-season screened porch.

MLS#6115841
\$375,000



SPACIOUS GREENWOOD LAKE LOT

Spacious, wooded lot gently sloping to the waterfront. There are very nice views of the majestic Greenwood Lake, with 338ft of shoreline and 3.65 acres. Mature White Pines and a seasonal creek set this property apart. Owners have done cleanup of deadfall to open up more lake views.

MLS#6112437 **\$259,000**

HOMES AND CABINS



COZY LOG CABIN ON 83 ACRES

One bedroom, 1 bathroom, log cabin on 83 acres, bordered by MN State land. Catch a glimpse of Lake Superior on a clear day from the bedroom window. Interior is accented by beautiful diamond willow railings and custom ironwork. Propane lights, refrigerator and cooking range reduce utility expenses.

MLS#6112373 **\$279,000**



SINGLE WIDE TRAILER ON 2.5 ACRES

Nice, spacious, wooded property on the east side of Grand Marais with a huge yard and a single wide trailer that can be updated and inhabited or removed so you can start your own plans from scratch. Wood floored garage, fenced pet run, and a bunkhouse/tool shed included.

MLS#6116831 **\$175,000**



CHARMING TOFTE COTTAGE

Charming home in Tofte with seasonal views of Lake Superior. Includes 2 bedrooms, office, 1 bathroom, fireplace and a 1-car garage with shop or studio space. New water system and on demand water heater. Owner has made \$25,000 in improvements in the last 2 years.

MLS#6112828 **\$304,900**

www.RedPineRealty.com • info@RedPineRealty.com

VISIT OUR OFFICE TO SPEAK WITH A REALTOR. BUSINESS HOURS: M-F 9AM-5PM, SAT 10AM-4PM

HOMES AND CABINS



SPACIOUS 3+ BEDROOM HOME

Check out this spacious 3+ bedroom, 2 bath home! Home sits on 6+ acres, very close to Cascade River State Park and only a 12 min drive to Grand Marais. Many recent updates with a finished basement and plenty of room to spread out! The property feels very private! The large yard around the house is quite beautiful!

MLS#6116568 **\$399,000**



OFF GRID A-FRAME CABIN

Peaceful getaway on almost 9 acres of heavily wooded forest adjoining federal land. Property has an A frame cabin powered by the sun & everything you need to step away from it all. There are 3 murphy beds to help utilize the smaller space. The wood burning stove will keep you warm during the colder months.

MLS# 6116796 **\$165,000**



CHARMING GAMBREL HOME

A charming gambrel style home nestled in the woods within an easy drive from Grand Marais or Grand Portage. The house has all the comforts of home with 2 bedrooms, 1 bath, large rooms and an upper loft area. There are trails through the woods or head to the garage with plenty of space to pursue a hobby.

MLS# 6116783 **\$349,900**



TOFTE HOME - LAKE SUPERIOR VIEWS

Beautiful property with a pond and a prime Lake Superior view! Brand new updates have created a large, attractive space on the deck and in the screened porch to enjoy the natural beauty of every season! This 3 bedroom, 2 bath home would make a great year round residence or a vacation getaway.

MLS# 6116780
\$640,000

CONDO



CARIBOU HIGHLANDS CONDO

Experience life at Caribou Highlands with a view of Moose Mountain from your deck. An entire renovation of the unit was completed in September. Alpine unit features a great room style floor plan with a loft bedroom. Enjoy your condo as often as you like and defray costs by participating in the optional rental program.

MLS#6116213
\$275,000

LAND/BUILDING SITES

MLS#	ADDRESS	CITY	PRICE	ACRES	DESCRIPTION
6112002	4XX-C LOST LAKE RD	HOVLAND	\$37,500	20.13	REMOTE, END OF THE ROAD PRIVACY
6113950	XXC PINE PEAK RD	LUTSEN	\$55,000	2.15	DEEDED ACCESS TO TAIT LAKE
6112701	XXB PINE PEAK RD	LUTSEN	\$65,000	2.64	DEEDED ACCESS TO TAIT LAKE
6111840	L4 B1 CROSSWIND TR	TOFTE	\$70,000	2.19	SEASONAL LAKE SUPERIOR VIEW
6114892	2XX-C W 11TH AVE	GRAND MARAIS	\$80,000	.27	DRIVEWAY & BUILDING PAD PREPPED
6114894	2XX-F W 11TH AVE	GRAND MARAIS	\$80,000	.28	DRIVEWAY & BUILDING PAD PREPPED
6113513	ABC LOST LAKE RD	HOVLAND	\$139,000	79.35	ADJOINS JUDGE MAGNEY STATE PARK
6115303	XX BLACK GRANITE TR	HOVLAND	\$160,000	80.0	POTENTIAL FOR SUBDIVISION
6114472	16XX CARIBOU TR	LUTSEN	\$229,000	40.0	ROAD FRONTAGE ACCESS ON 2 ROADS
6112490	XXXX-1 JACKSON LAKE RD	HOVLAND	\$425,000	39.64	PANORAMIC LAKE SUPERIOR VIEW
6113698	4177 JOSHUA RD	SILVER BAY	\$125,000	25.86	ON THE EAST BRANCH OF THE SPLIT ROCK RIVER
6116520	#7 MURPHY DR	GRAND MARAIS	\$75,000	5.37	5 MILES FROM GRAND MARAIS
6116523	#11 MURPHY DR	GRAND MARAIS	\$125,000	5.01	5 MILES FROM GRAND MARAIS

RECENTLY SOLD

ADDRESS	CITY	SOLD PRICE	PROPERTY TYPE	ACRES	DESCRIPTION
2717 COUNTY RD 7	GRAND MARAIS	\$135,000	BUILDABLE LOT	7.51	YEAR ROUND ROAD ACCESS
10 BIG BAY PT	HOVLAND	\$491,000	LAKE SUPERIOR LOT	1.90	LAKE SUPERIOR SHORELINE
22 E 1ST ST	GRAND MARAIS	\$1,425,000	COMMERCIAL	.12	LAKE SUPERIOR COMMERCIAL
LOT 6 BLOCK 1 MURPHY DR	GRAND MARAIS	\$75,000	BUILDABLE LOT	5.72	BUILDABLE LOT



COLDWELL BANKER
NORTH SHORE

218-387-2131

101 WEST HIGHWAY 61
GRAND MARAIS, MN 55604

LAKE SUPERIOR



NEW 4556 CASCADE BEACH ROAD

Looking for a stunning Cascade Beach Road retreat? This Scandinavian inspired 3BR/2BA home on 200' of Lake Superior shoreline is it! Whether you dream of waves lapping on the ledge rock shoreline, the moonlight glistening on night waters, or vibrant painted sky sunrises, this property does not disappoint. The kitchen is open to a lovely dining room complete with a fireplace and an amazing expanse of windows framing a spectacular lake view. The spacious primary bedroom is a true sanctuary, with vaulted ceiling, skylights, and panoramic view of the lake.

MLS 6117163 \$1,295,000



NEW 4190 CASCADE BEACH ROAD

Nestled along Cascade Beach Road, this charming one-room cabin offers an idyllic retreat with 93 feet of private Lake Superior ledge rock shoreline. Inside, you'll find a cozy space featuring a stone fireplace, warm wood floors, and a compact loft for additional sleeping. Unwind on the inviting 3-season porch, where you can enjoy breathtaking panoramic sunrises and the shimmering waters of the lake. The ledge rock is incredibly accessible, and you will spend hours pondering life at the lake, while listening to the waves roll in, it just doesn't get any better.

MLS 6117188 \$579,900

LAKE HOMES & CABINS



22 AUSTIN'S LANDING

Experience luxurious log home living on 300+ feet of Poplar Lake shoreline. This custom 4-bedroom, 4-bath home features a gourmet kitchen, inviting living spaces, a spacious library, and a bonus room. Enjoy breathtaking lake views, direct BWCA access, and prime dining nearby.

MLS 6116128 \$1,595,000



185/187 SAG LAKE TRAIL

Discover this exceptional 4BR/3BA home nestled along the scenic Gull Lake, with 467' of frontage and approximately 5A of land, complete with rock outcroppings, pine trees, stunning views, and plenty of privacy. Ideal for the buyer wanting to enjoy paddling from their dock into the BWCAW. This meticulously maintained property features a back-up generator system, attached heated garage, HUGE spacious heated garage, and workshop along with two charming rustic sleeping cabins.

MLS 6114568 \$1,500,000



218 BRUMBAUGH ROAD

Charming Tom Lake cabin is being sold turnkey so all you have to do is show up and start enjoying lake life! Situated near the water's edge, on a beautiful 2.4A lot with stunning views and is in a protected harbor with a approximately 300' of shoreline.

MLS 6112837 \$349,000



11 POPLAR CREEK DR

Picturesque haven just off the Gull Lake Trail offers an exceptional opportunity to own a versatile property. This unique property features 12 acres of land with 309 feet of frontage that abuts the Boundary Waters Canoe Area.

MLS 6114875 \$599,900

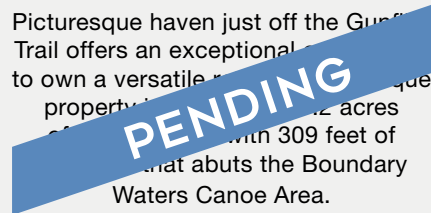

167 SOUTH SHORE DR

Delightful 3BR/2BA Devil Track Lake home. Expansive windows, open living space with natural light, and a large deck and porch. Features a two-stall garage and a wood-fired sauna building.

MLS 6116646 \$599,900



WWW.CBNORTHSHORE.COM



COLDWELL BANKER
NORTH SHORE

218-387-2131

101 WEST HIGHWAY 61
GRAND MARAIS, MN 55604

HOMES & CABINS



845 COUNTY ROAD 14

3BR/2BA home on 10A offers 1,846 square feet of inviting living space, blending seamlessly with nature. Features include vaulted ceilings, a woodstove, spacious deck, and a 2+ stall garage.
MLS 6115762
\$425,000



REDUCED

451 LINDSKOG ROAD

Perfect blend of rustic charm and modern living in this delightful 4BR/2BA farmhouse on 20A featuring a private pond. Don't miss this opportunity to have your own wooded retreat only a few short miles from Grand Marais.
MLS 6116800
\$499,900



LAND

COMMERCIAL



257 SEAGULL LAKE RD

Exceptional Seagull Lake property with tons of privacy. 10+A with over 480' of lakeshore ranging from a sandy beach to ledgerrock outcroppings. Brand new floating dock, camper in mint condition, and 960' oversized insulated garage.
MLS 6113853 \$539,900

NEW XX BALLY CREEK RD

Exceptional 26+ acre property nestled on the scenic Bally Creek Road, with the Cascade River flowing right through it. Offering unparalleled privacy, this land directly adjoins state and federal land on three sides. The gently rolling topography will easily accommodate your planned cabin or camp site. Access the river for a perfect spot to cool off during summer months or just relax and enjoy sounds of the rushing water.

MLS 6117080 \$175,000



1315 E HIGHWAY 61

Incredible commercial opportunity. Current use includes office, unit, office, and parking and great location!

MLS 6104280 \$995,000

PENDING

XX MURPHY DRIVE

Discover your sanctuary among five lush acres of dense forest, located minutes from downtown Grand Marais on an end of road location to increase your privacy.
MLS 6114679 \$69,900

XX RAVENWOOD DRIVE

Your dream home is waiting to take shape on this fantastic lot close to the heart of downtown Grand Marais. Partially cleared build site and a roughed-in driveway.
MLS 6116834 \$82,000

11XX HIGHWAY 61 W

Unique opportunity to find a 1A lot in the heart of Grand Marais. Directly abuts Highway 61, with commercial usage, perfect for someone considering a home for their business or wanting to build short-term rentals.
MLS 6114985 \$169,900

12XX HIGHWAY 61 W

RARE opportunity to find almost 6A of mixed use located in the heart of Grand Marais, with city sewer and city water. This property has approximately 825' of frontage on Highway 61 and access off 1st Street.
MLS 6114986 \$689,900

WWW.CBNORTHSHORE.COM

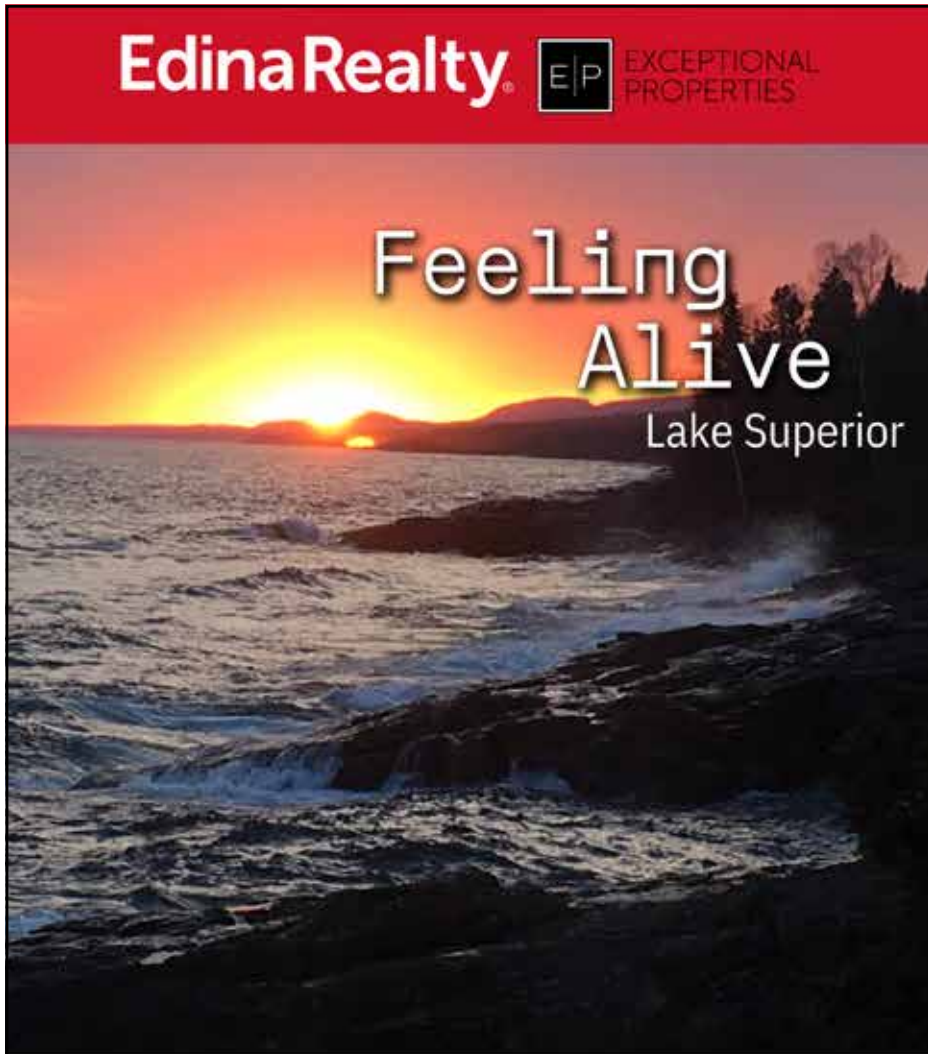

Edina Realty  EXCEPTIONAL PROPERTIES

Feeling
Alive
Lake Superior

Inger Andress REALTOR

Licensed in MN
218-216-7141
IngerAndress@edinarealty.com
edinarealty.com/inger-andress-realtor
Home Staging to Sell, Expert
www.homestagingexpert.com/minnesota

North Shore Homes | Luxury |
Lake Shore | Land | Cabin

Buying or selling, call me today!



**SONGBIRD
REALTY MN**

WE APPRECIATE YOU!

We'd like our clients and customers to know how much we appreciate each and every one of you. It has been our pleasure to work with you and we at Songbird Realty MN are truly grateful. We look forward to working with you and new clients/customers in the future and wish you all a fantastic 2025!



LINDA GARRITY
Broker & Owner
218-370-8313



KELLY HANSEN
Agent
612-701-4062

Please reach out if you have any questions about the market, listing your home or want help finding that place you've been dreaming of. Happy to help!

P.O. Box 397
411 W. Highway 61
Grand Marais, MN 55604

1008 2nd St. N.
Stillwater, MN 55082

songbirdrealtymn@gmail.com
www.songbirdrealtymn.net



**Northern Wilds
Real Estate**

Covering the communities in
the North Shore area from
Duluth, MN past **Thunder Bay, Ont.**

Check in with any of our
advertising Real Estate Agents
for information on how to
buy or sell your property.

Subscribe to our free online magazine
with listings: **northernwilds.com**

Come for a Vacation, **STAY FOREVER.**

At Lutsen Real Estate Group, we'll help you find the perfect home on the North Shore. Whether you're looking for a cozy retreat or an investment for the future, our team's deep local knowledge and passion for the region will ensure you find a property that meets your aspirations.

Supported by Cascade Vacation Rentals, we offer unmatched insights into the vacation rental market. This expertise increases the potential for a strong return on your investment.

TURN YOUR VACATION INTO A FOREVER STAY.



MOLLY O'NEILL | Agent
(218) 370-2079
molly@lustenrealestategroup.com



MIKE LARSON | Associate Broker
(218) 370-1536
mike@staycvr.com



SARENA CROWLEY
Agent and Co-owner



CLAIR NALEZNY
Co-owner



STEVE SURBAUGH
Broker and Co-owner



Cheers to the New Year!
 Start the Year off Right on the North Shore!
Info@TimberWolffRealty.com

Call TimberWolff for
 Your Personal Tour of
 Homes & Land!!!
 Local (218) 663-8777
 Toll free (877) 664-8777

VIEWS GALORE!



BEAUTIFUL, REMOTE 40 ACRES WITH DRAMATIC LAKE SUPERIOR VIEWS!

Close to Grand Marais, part of Murphy Mountain, off the Bally Creek Rd. Access road in place. Subdivision possible or keep whole as a dreamy preserve and home site. Abuts miles of public land! Price reflects incredible vibe, views, solitude and grandeur! Make it your own.
\$400,000 MLS#6117131



NEW! ENJOY THE WILDERNESS AT TAIT LAKE!

Out amongst the Tait Lake Pines in Lutsen, at the end of the road, is this peaceful, tucked away lot. Nearly three acres but feels larger as it abuts miles of public lands to the south and dedicated open space to the east. Current owners have provided a good start with clearing, dirt-work preparation and building sites. Great Location close enough to all the fun: skiing at Lutsen Mts, golf at Superior National, paddling the BWCA, hike Eagle Mt. Also, plenty to do right in the 'hood: dedicated neighbors have developed a sweet trail system in the open HOA lands. 2 private HOA docks provide access to Tait Lake. Come get your foothold in the cool north, living life in a lakeland wilderness.

MLS#6116905 \$92,500



LUTSEN PARCEL- MOUNTAIN OR LAKE VIEW - YOU DON'T HAVE TO CHOOSE!

Over 5 acres of high ground overlooking Tait Lake in Lutsen. The land offers nice views of Eagle Mountain, the highest point in Minnesota! High views of Tait Lake, framed by mature old growth White Pines. The Tait Lake area is known for its environmentally friendly wilderness area, about 20 minutes up the Caribou Trail in Lutsen. Year-round access, power at the build site and lake access available to Tait Lake owners via a private landing just a few minutes from this parcel.

MLS# 6117010 \$95,000

WATER, WATER, WATER AND THE BIG LAKE!



NORTHERN ENLIGHTENMENT ON PIKE LAKE!

MLS#6115941 \$749,000



LOG CABIN LIVING ON TUCKER LAKE!

\$539,000 MLS#6115815



HAPPY PLACE IN ISABELLA!

MLS#6115711 \$339,900

FIND THOSE NEW LISTINGS FIRST!!

EMAIL INFO@TIMBERWOLFFREALTY.COM TO SIGN UP FOR AUTO EMAIL!



Cheers to the New Year!
 Start the Year off Right on the North Shore!
Info@TimberWolffRealty.com

Call TimberWolff for
 Your Personal Tour of
 Homes & Land!!!
 Local (218) 663-8777
 Toll free (877) 664-8777

HOMES, HOMES, HOMES, READ ALL ABOUT 'EM!!

**BEAUTIFUL
 CUSTOM HOME
 ON LEVEAUX
 MOUNTAIN
 IN TOFTE!**

Awake each morning to the beautiful sunrises over Lake Superior from the primary suite of this architecturally designed home. LeVeaux Mountain is part of the Sawtooth's range between Lutsen and Tofte, a perfect location to enjoy Lutsen Mountains Summer and Ski Resort or a nice dinner at Blue Fin Bay Resort in Tofte on Lake Superior, both just minutes away. Accommodating kitchen features lots of cabinetry and gathering space! Cozy up to the stone fireplace for your morning coffee, or a good book. This home has great spaces, you must see to appreciate all that this home has to offer! Hike, ski, or snowshoe from your front door in to the Superior National Forest, with a spur trail to cross country ski trails nearby! An outdoor enthusiasts dream home, close to everything the North Shore offers!

MLS# 6115360
\$549,000
PRICE
REDUCED



SOLD



CREATE YOUR OWN GETAWAY ON THE PIKE LAKE ROAD!!

Prime location north of Babineau Corner - out in the wonderful woods of the Superior National Forest! Yet not too far to Grand Marais and all the fun and doins' there! Cabin is all about functionality and creating memories! Two bunkbeds make this place the ideal deer camp, family getaway, or open it up and make the place a studio for dreaming big and making stuff! Big 'ol deck for BBQing, bird-watching, aurora borealis viewing, or just watching the sunsets each day... heck take a nap. Spacious shed keeps all the tools and a Legitimate, tidy outhouse. North side of lot has a good build site, well away from the cabin. 13+ acres of elbow room and "plays" even larger, abutting public land on the north side. The SW corner "kisses" public land, too. Come have a look: dream a bit and get going on that vision of realigning with your goals, the plan of getting a foothold Up North!

MLS#6116947 \$199,000



SOLD

CUTE CABINS TUCKED AWAY IN THE WOODS OF GRAND MARAIS!

Here is what happens when an upland, south-facing section of Boreal Woods meets a talented carpenter with a retreat vision: cabins of character appear. One is for sleeping, thinking, reading and dreaming. The other for cooking, gathering and story-telling. Come reimagine yourself, that's the vibe here - from the materials to the conversation, to the transitioning winds and temps. This is enough for most, but there's more! 6+ acres that "play" larger, abutting public lands on two sides. Maybe back in there is a future homesite, the cabins can be for guests. Water collection comes off three of the roofs. Power and fiber are down at the start of the driveway. Nice mix of woods sways around: maples, aspen, birch, spruce. This is a creative, evolving space... come center yourself in the "courtyard" and take the reins.

MLS#6116829 \$169,000



SOLD

LUTSEN'S OZ! YOU'RE NOT IN KANSAS ANYMORE... AND THIS DREAM IS REALITY!

MLS#6115382
\$495,000



SOLD

COUNTRY LIVING ON THE PIKE LAKE RD!

MLS#6115304
\$499,000

VISIT US AT TIMBERWOLFFREALTY.COM CHECK OUT OUR WEEKLY BLOG AND FACEBOOK POSTS OF FUN TIMES ON THE NORTH SHORE!



Cheers to the New Year!
 Start the Year off Right on the North Shore!
Info@TimberWolffRealty.com

Call TimberWolff for
 Your Personal Tour of
 Homes & Land!!!
 Local (218) 663-8777
 Toll free (877) 664-8777

CAMPN', HUNTN', FUN GETAWAY LAND, INVEST IN YOUR FUTURE!

FINLAND AREA

ENJOY THE QUIET LIFE IN FINLAND! Settle in and enjoy the sounds of the woods on 15 acres. This property connects directly to snow. **SALE PENDING** It's an ideal spot for the outdoor winter season on a county road! The backside of the property has a pond and marsh, great area to see the local wildlife! **MLS#6116819 \$49,000**

EXPLORE THE WILDERNESS IN FINLAND!

What a great spot for your vacation getaway cabin!! This lot has great views of Ninemile Lake in the Village at Ninemile planned development. The infrastructure is already there: electricity, shared well and septic, all you have to do is hook up to it. Shared ownership of approx. 1800 ft of shoreline on Ninemile Lake, perfect for Summertime fun! **MLS#6113405 \$60,000**

AFFORDABLE LOT AT NINEMILE LAKE!

Lake view lot ready to build, with 1800 ft of shared shoreline on Ninemile Lake! The Village at Ninemile Lake has all the infrastructure ready to go with shared septic and well, electricity at the lot. County Rd 7 is a year round plowed road and the Association plows the roads within the development! This is a great opportunity to build your dream getaway!
MLS#6113406 \$60,000



OUTDOOR ENTHUSIAST'S DREAM AT NINEMILE LAKE!

Start enjoying your Inland Lake Dream! This lot was created by combining two lots, so it offers plenty of room to build your dream cabin or home with an amazing lake view and direct lake access! Shared Septic System and Well already in place, 1800ft of shared shoreline on Ninemile Lake- all that is missing is you and your plans for a dream getaway! **MLS#6113407 \$150,000**

LUTSEN AREA



NEW! SAVOR NATURE AT TAIT LAKE!

Amongst the Tait Lake Pines in Lutsen, at the end of the road, is this nearly three acre lot. Feels larger as it abuts miles of public lands to the south and dedicated open space to the east. Current owners have provided a good start with clearing, dirt-work preparation and building sites. Great Location close enough to all the fun: skiing at Lutsen Mts, golf at Superior National, paddling the BWCA, hike Eagle Mt. 2 private HOA docks provide access to Tait Lake. Come get your foothold in the cool north, living life in a Lakeland wilderness.
MLS#6116905 \$92,500

LUTSEN PARCEL- MOUNTAIN OR LAKE VIEW - YOU DON'T HAVE TO CHOOSE!

Over 5 acres of high ground overlooking Tait Lake in Lutsen. Nice views of Eagle Mountain, best point in Minnesota and High views of Tait Lake. Mature old growth White Pines. Year-round power at the build site and lake access available to Tait Lake owners via 2 HOA docks!
MLS# 6117010 \$95,000

GRAND MARAIS AREA



GREAT OPPORTUNITY FOR PURCHASING OVER 2 ACRES IN THE CITY OF GRAND MARAIS!

You don't have to give up solitude to live in the city of Grand Marais, this is a perfect fit for a home with a great location. The YMCA and school are within walking distance and just a hop, skip and jump to the Gunflint Trail to access numerous trails for hiking, biking and snowmobiling and MANY inland lakes. Visit today and start your dream of enjoying the North Shore!
MLS#6114386 \$111,000 PRICE REDUCED

GRAND MARAIS AREA



NEW! BEAUTIFUL, REMOTE 40 ACRES WITH DRAMATIC LAKE SUPERIOR VIEWS!

Close to Grand Marais, part of Murphy Mountain, off the Bally Creek Rd. Access road in place. Subdivision possible or keep whole as a dreamy preserve and home site. Abuts miles of public land! Price reflects incredible vibe, views, solitude and grandeur! Make it your own. **MLS#6117131 \$400,000**



REMOTE 80 ACRES OFF THE GUNFLINT TRAIL IN GRAND MARAIS!

Looking for a truly remote property? Here are 80 acres surrounded by federal land just south of the South Brule River and a bit west of the Gunflint Tr. Crossing the South Brule River is necessary in route to property, No formal access exists currently. Prospective buyers are encouraged to contact the US Forest Service regarding establishing a special use permit for a path once they own the property. Moose tracks are plentiful. Wild, pure forest pulses along here - undisturbed, quiet and beautiful. The northern forty acres rolls and is a mix of upland and some lowlands. Go south, begin to climb, pass some giant ole' aspens heading to some terrific views! Plenty of elbow room to expand the mind and soul. Get away from it all!
MLS#6113905 \$62,000 PRICE REDUCED

FIND THOSE NEW LISTINGS FIRST!!

EMAIL INFO@TIMBERWOLFFREALTY.COM TO SIGN UP FOR AUTO EMAIL!