

DECEMBER 2018

THE NORTH SHORE'S ULTIMATE
REAL ESTATE
GUIDE





Lynne Luban

Over 12 years selling downtown MPLS Condo living. Currently representing this developers 10th project PORTLAND TOWER & THE LEGACY. I am available to meet with you in Grand Marais or Minneapolis to go over prices & floor plans.

Cell: 612-599-6986 Email: lynneluban@mac.com Website: thelegacyminneapolis.com

The LEGACY

263
~~740~~ SOLD
OCCUPANCY
FALL 2018



LIVE OUT YOUR LEGACY IN NEW CONDOS IN MILLS DISTRICT BY THE GUTHRIE!
CLOSINGS ARE BOOKED SOLID FOR AUGUST, SEPTEMBER, OCTOBER, NOVEMBER, DECEMBER!
Contact me for a personal viewing of floor plans photos of construction views and pricing.

There's a NEW CONDO BUILDING in DOWNTOWN MINNEAPOLIS
112 units with 79 SOLD! • 7 units available for immediate occupancy • 40 still available to customize.

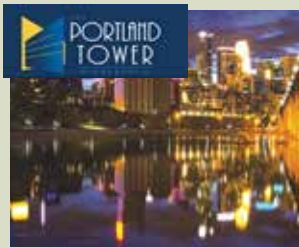

A New Luxury Condo Development
740 Portland Avenue • Downtown Minneapolis

- 17 story New Construction
- Pet-friendly building
- High end standard features
- Community and Fully equipped exercise room, and outdoor roof top green space
- Climate controlled parking
- Just a few blocks from US Bank Stadium
- Additional garage stalls available for purchase
- Walk the Skyway for all your needs
- Within a few blocks of Lightrail
- Close to the Nicollet Mall
- Choose from many restaurants close by!
- Walk two blocks to the new 9 acre Commons Park that extends from the US Bank Stadium to Portland Avenue.
- Choose from many available options to customize your unit.





TALK TO TERRY!

TERRY R. BACKLUND
 BROKER/OWNER
LORI A. BACKLUND
 REAL ESTATE AGENT



PHONE: 218-387-1501 CELL: 218-370-8977 TERRY@BACKLUNDREALTY.COM

635 CTY. RD. 6 GRAND MARAIS, MN



2+ Bedroom 2 Bath
 1176 sq.ft.home on 5 acres
 MLS# 6079593 Price: \$179,000

69 BIRCH DRIVE GRAND MARAIS, MN



1170 Sq. Ft. on 4.75 Acres
 MLS# 6078632 Price: \$154,900

1620 E HWY 61 GRAND MARAIS, MN



4 Bedroom 5 Bath 2 Car Garage
 Huge home at 3900 sq. ft.
 MLS# 6077992 Price: \$318,750

207 E DEERYARD RD GRAND MARAIS, MN



864 sq. ft. home 2 Car Garage 7.26 Acres
 MLS# 6078073 Price: \$169,900

117 W 6TH AVE W. GRAND MARAIS, MN



3 Bedroom 3 Bath
 3800 Immaculate sq. ft.
 MLS# 6078106 Price: \$319,000

EAST PINE MTN. RD. GRAND MARAIS



6.7 acre parcel. Close to GM
 MLS# 6074988 Price: \$39,500

10 ONGSTAD RD. HOVLAND



338 ft. of Lake Superior on 14.53 acres.
 1 Bedroom Cabin, Garage, Dock
 MLS# 6029532 Price: \$319,000

5712 E HWY 61 HOVLAND, MN



2 Bedroom 2 Bath 1500 Sq. ft. 2 Car Garage
 420 ft. Lake Superior shoreline
 MLS# TBD Price: \$499,900

319 2ND AVE W. GRAND MARAIS, MN



Classic 4 Bedroom 2 Bath with large porch. Additional 440 sq. ft. cabin
 MLS# TBD Price: \$362,000

4800 E HWY 61 HOVLAND, MN



3 Bedroom 2 Bath 2800 Sq. ft. 3 Car Garage 455 ft. Lake Superior shoreline 4.40 acres
 MLS# TBD Price: \$649,900

4038 CASCADE BEACH RD. LUTSEN, MN



2 Bed 1 Bath 780 sq. ft. cabin
 3 Car Garage with 1277 sq. ft. loft
 3.93 acres on 248 ft of Lake Superior shoreline.
 MLS# TBD Price: \$780,000



PHONE: 218-387-1501 CELL: 218-370-8977 TERRY@BACKLUNDREALTY.COM



NORTH SHORE

www.CBNorthShore.com
Serving Cook County since 1971

(218) 387-2131
(800) 732-2131
101 West Hwy. 61
Grand Marais, MN 55604
info@cbnorthshore.com

On Lake Superior



68 Trailsyde

Extremely rare opportunity to purchase over 1000' of beautifully rugged and secluded Hovland Lake Superior shoreline with over 30 acres of land to ensure ample exclusivity and privacy. Property is amazing and includes an unfinished concrete mansion structure plus a guest cabin. Whether you subdivide or keep it as an exclusive retreat, you won't find another property like this one!

MLS 6026201 - \$995,000



16 Beargrease Crossing

Spectacular 4BR, 3BA Lake Superior home on a private 5.26 lot that includes a waterfall, 276 ft. of ledgerrock, gravel beach shoreline and minutes from Grand Marais. Gourmet kitchen with huge island, stainless steel appliances & a lovely farm kitchen sink; floor to ceiling fireplace; walk out guest suite; south facing windows for views & sunlight. Includes a large heated garage with a studio.

MLS 6077977 - \$770,000



22 E Rosebush Lane

Marvel at the views of Artist Point from this stunning 4 bedroom, 4 bath premier home located west of Grand Marais. Must see to appreciate the custom tile work, built-ins, floor to ceiling windows, cobblestone fireplace, decks and expansive gourmet kitchen & much more. Home is complete with AC, back-up generator & oversized garage. Private 2.96 acre lot with 243' of gravel shoreline.

MLS 6075855 - \$890,000



Schroeder Lots

Massively expansive ledge rock shoreline make these two lots some of the most amazing shoreline you will see on the North Shore. Lots are 2+ acres and 200 ft wide with significantly more meandering shoreline.

MLS 6078583 \$299,900
and **6078584 \$339,900**



8650 W Hwy 61

Talk about your Lake Superior value!!!! This 2 acre Schroeder lot has plenty of privacy, year round creek AND an incredibly beautiful Lake Superior ledge rock beach with a private inlet to launch your kayaks. Large, roomy 3 bedroom, 2 bath manufactured home.

MLS 6078585 - \$269,900

Lake Superior Lots



2888 W Hwy 61, Grand Marais

Fabulous views of both Artist Point and the Sawtooth Mountains! Stunning Lake Superior lot with 1.24A, 200' ledge rock shoreline embedded with Thomsonite Stones, making this piece of Lake Superior Shoreline truly unique.

MLS 6076120 \$239,900

Stonegate Rd, Hovland

Lovely Lake Superior lot, located on the scenic Chicago Bay Road. Nicely wooded, private, and well insulated from Highway 61, this lot offers an escape with no inconvenience.

MLS 6030329 \$189,900
and **6030330 \$194,900**



PENDING 4794 Chicago Bay, Hovland

Quality built, well designed 3 BR, 2 BA Lake Superior home complete with a floor to ceiling cobblestone fireplace; fantastic kitchen with plenty of storage; vaulted ceilings; fully updated bathrooms and a sunny 4 season porch.

MLS 6074208 \$499,900

condos

Bluefin Bay Tofte

MLS 6075832 Unit 55, 3BR, 3BA **\$569,500**
MLS 6074681 Unit 32, 1 BR, 1BA **\$275,000**

MLS 6078520 Unit 26, 1BR, 1BA **\$259,900**
MLS 6078275 Unit 18, 2 BR, 2 BA **\$340,000**



East Bay Suites

Check out these condos located in the heart of Grand Marais on the shores of Lake Superior. Great property if you are wanting a 2nd home or an investment property.

REDUCED
UNIT 210
MLS 6033341 \$319,000
3 BR, 2BA

UNIT 202
MLS 6074935 \$319,900
2 BR, 2 BA

Homes & Cabins



1473 Gunflint Trail

Cabin on the river anyone? Adorable one room year round cabin close to the water's edge of Devil Track River! Convenient location close to town. The land is stunning and complete with trails, bridges, perennial flowers!
MLS 6078182 - \$159,900



319 E 2nd Ave

Three rental units for the price of a single home, or the lower units can be combined leaving a family home with a studio apartment overhead. Or restore home into a two story single family home.
MLS 6027869 - \$168,000



54 Morgan Rd

Special one room getaway in the woods on 40A of mature trees, abuts Cascade State Park and Federal land! Beautiful Lake Superior Views. Garage and bonus space is quite functional as it is, or remodel as you desire.
MLS 6073759 - \$239,900



210 Bloomquist Mtn Rd

This 2BR, 2BA year-round home has all the modern amenities together with an open floor plan that is perfect for entertaining. Detached garage, ready for your toys all on 6+ acres of fields and amazing views of Lake Superior.
MLS 6032433 - \$176,000



Pending 2877 E Hwy 61

Eleven acres with outstanding views of Lake Superior. Bordered on the north by hundreds of acres of Federal land. You will love this charming, cozy timber-frame sauna/cabin.
MLS 6078377 - \$99,900



REDUCED 68 Springdale Rd

Sweet 1+ bedroom home that has been lovingly updated with many new features to include wood floors and an updated kitchen. Attractive neighborhood with a nice lot, featuring a stream that gently flows through the lot. Motivated Seller!
MLS 6079139 - \$133,900



2291 Cty Rd 7

Stylish 3 BR, 2 BA country estate on 10A complete with ponds, an artist's cabin and Lake Superior Views. This magnificent home was designed and built for horse riding with the large horse arena and fenced in yard. Must see to appreciate!
MLS 6075061 - \$699,900



16 Cliff Cove

Spacious 4BR, 2BA home with lots of woodwork and old world charm, on a landscaped 4.64A lot in Schroeder. Enjoy the open floor plan, with a wood burning fireplace, and the 3 season sunporch, perfect for sunsets.
MLS 6077691 \$229,900



502 2nd Ave E

Attractive 3BR, 2 BA home with many updates. Modern kitchen with a large island & granite counters. Walkout lower level with family room, including a kitchenette, which can be rented.
MLS 6078096 - \$299,900



418 4th Ave W

Spacious 4 BR home on a large corner lot with a 5-stall garage & 24x24 workshop. Features vaulted ceilings, open floor plan, huge windows surrounding the gas fireplace and an updated kitchen.
MLS 6075590 - \$375,000

Inland Lake Homes

Commercial



100 Sag Lake Trl

Own a Piece of paradise on the Saganaga Lake! Primary cabin features 2 BRs, 1BA with a spacious open floor plan. Adorable guest cabin with knotty pine woodwork, bath & kitchenette. Large garage! All of this on 1.3A with 150' of shoreline & dock.
MLS 6075388 - \$379,900



Wilson Lake

HUGE savings with this oversized lot with 4 plus acres & over 335' of shoreline. Many improvements in place - a driveway; site prep work - partially completed; a septic system and a well!!! Grab your floorplans and start dreaming!
MLS 6075594 \$168,000



8 N. Broadway

Prime commercial property has immediate income. Two upper level apartments with space for more, plus storefront, and grounds rental. For Grand Marais the location could hardly be better for tourism and traffic potential.
MLS 6029037 \$437,900



Pike Lake

Year round 3 bedroom, 2 bath home with walkout lower level is situated on 2A and 155' of easily accessible shoreline on the west end of Pike Lake. Use it for your personal retreat or a VRBO.
MLS 6075052 - \$359,900



Pending 113 Winter Wren

One room cabin is situated on 1.5A with 263' of shoreline on West Twin Lake. Wonderful views of the surrounding hills and bluffs and the user-friendly lake-shore makes it easy to launch your canoe or kayak.
MLS 6075942 - \$125,000



Pending Greenwood Lake

Private cabin on the coveted Greenwood Lake! Very private lot with 4.59A, 366' shoreline, private bay, very accessible waterfront, dock, sandy swimming area, walking trails, mature trees and year round access.
MLS 6078729 - \$179,900

1st Ave West

Great opportunity in the downtown business district! This building is located on 1st Avenue West close to the harbor, Wisconsin Street, and Highway 61. Busy retail area year round--heavy foot traffic all summer long! A cafe, jewelry store, and t-shirt shop have all prospered at this location--what is your dream business?
MLS 6075583 \$224,900



Land



Whispering Pine
Private lot at the end of Wes Hedstrom Trail, just high enough for a view of Leo Lake. Convenient location mid-Gunflint Trail.
MLS 6077021 - \$45,000

1XX Quist Road
Close to town, this 5 A lot is set up for your vacation cabin or YR home with potentially spectacular views of Lake Superior.
MLS 6076218 - \$57,000

19XX Camp 20 Road
Affordably priced 20 acre parcel with privacy, situated near Federal land to the north. Seasonal access off of the Camp 15 Loop Rd in Hovland.
MLS 6076349 - \$24,900

West Hwy 61 - Grand Marais
Attractive & affordable building site with 3+ acres & easy access right off of Hwy 61. Minutes from town and connects to the Superior Hiking Trail.
MLS 6078588 - \$44,000

Railroad Drive - Lutsen
Sweet 1.7 A building site located in the heart of Lutsen. Gently rolling topography, mature trees - easy building site and near many recreational opportunities.
MLS 6023743 - \$39,900

County Road 7
Check out this property with 2.27 acres within city limits. Build your home or consider doing a subdivision.
MLS 6075749 - \$55,000

North Rd - Hovland
Affordably price 20 acre lot that is perfect for a private, year round retreat. Power, phone and broadband available at the road.
MLS 6024552 - \$39,900

XX Boulder Point Rd
Attractive YR building site with 3.22 A; private driveway; seasonal creek and gentle southern slope with some partial views of Lake Superior.
MLS 6078705 - \$59,900

County Road 67 - Grand Marais
Breathtaking views of Lake Superior from this 2.24 A lot. Year round access, surveyed, private driveway and directly abuts State land to the east.
MLS 6029973 - \$39,900

10 Murphy Mtn Rd - Grand Marais
Dream about your future home while relaxing in the screened in porch. Lake Superior views, 5+ acres of rolling topography, driveway & utilities in place.
MLS 6073521 - \$49,900

14x Bloomquist Mtn Rd
Ten acres of mature trees including huge White Pines! Sloping lot with lots of southern exposure for sunshine all year long.
MLS 6075850 - \$59,900

3143 East Highway 61
Attractive 1.84 acre, year round lot with a south facing elevation, perfect for a walk out. Additional land available and owner will carry a CD.
MLS 6079521 - \$39,900

313X East Highway 61
Fantastic lot with 20.89 acres, that could be subdivided. Features a pond, great views & healthy trees. Owner will carry a CD.
\$159,900

310X East Highway 61
Nice lot east of town with 5.56 Acres; excellent topography lines. Lake Superior Access across the road. Owner will Carry a CD.
\$59,900

Lot 7 LeVeaux Ridge
Beautiful and affordable lot, with electricity, phone and broadband on site, abuts to State land for added privacy! Close proximity to many recreation options!
MLS 6077826 - \$29,900

New 1643 Caribou Trail
Location, location, location! 40 A, surrounded by Federal land, yet features year-round access, electricity, broadband and phone for a truly convenient home site. Rare acreage with frontage on The Caribou Trail! Potential to subdivide and a motivated seller!!
MLS 6079699 - \$129,900

Large Acreage



160 Acres Gunflint Trail
Remote, yet not far away from many mid-Gunflint Trail resorts. Incredibly unique chunk of land surrounded by USFS & abutting the BWCA for the ultimate northwoods getaway. Extremely close to Iron Lake. Access is a little rough!
MLS 6074802 - \$139,900

110 Acres 180X W Gauthier Rd
110 acres of privately owned acreage directly abutting Judge Magney State Park, with distant Lake Superior views. Direct access to the Superior Hiking Trail, with plenty of wildlife to observe!
MLS 6079702 - \$110,000

170 Acres Camp 20 Rd
Heavily forested land that has been replanted with pine trees. Rolling topography, many building sites and hiking trails. Features a gravel pit on the northwest corner and a small wildlife pond to the south. State land to the south & east.
MLS 6074422 - \$149,900



Moose Valley Land
Imagine owning 700 acres of contiguous land that abuts State Land & is 2 1/2 miles in length? Multiple road access points from Highway 61 to Moose Valley Road to Whippoorwill Road. Property is abundant with wildlife; natural ponds; spectacular Lake Superior views; driveways and trails! Whether you keep this as one parcel or subdivide, the options are endless. Priced to sell and Owner will Carry a CD.
MLS 6079583 \$399,900



Moosehorn Lake
AMAZING 220 acre parcel, totally surrounded by Government Land. This includes the only private ownership on Moosehorn Lake, which is known for Trout Fishing. There is a private driveway off of the Arrowhead. Stunning views overlooking Stevens Lake; rolling topography; lots of privacy & wildlife; and relatively close to year round access. Priced to sell and Owner will Carry a CD.
MLS 6079579 \$269,900

Inland Lake Lots



Poplar Lake
Convenient mid-Gunflint Trail 2.75 acre building site featuring deeded lakeshore access. Building site cleared, driveway in, utilities available.
MLS 2158160 - \$52,500

Onagon Lake
Amazing building spots with views overlooking both Onagon and Cupid Lake. 5 A and over 1000' of shoreline between both lakes.
MLS 6078278 - \$99,900

Greenwood Lake
Attractively priced lakeshore lot with 4.2A and 300' rocky shoreline. Covered trout lake, year round access - perfect for cabin or home site.
MLS 6073512 - \$139,900

Onagon Lake
Nice lot just minutes from Sea Gull and Sag Lake with BWCA access. Consists of 1.1 A with 222' of shore. Priced to sell!
MLS 6078276 - \$39,900

Poplar Lake
Private lot with over 2 acres & 250' of rocky shoreline on Fireplace Road. Great open lake views and a Southeastern exposure provides a perfect building site.
MLS 6077828 - \$139,900

Squint Lake
Mid-Gunflint Trail lot with 2.13A & 221' shoreline. Gently rolling topography, old white pine trees & abuts USFS! YR access, elec & broadband.
MLS 6028920 - \$75,000

Tom Lake
Enjoy stunning sunsets and views of the Palisades! Year round access, 171' shoreline, driveway and a cleared building site plus a stairs to the lake for easy access.
MLS 6076516 - \$49,900

Tom Lake
One of the nicest lots on Tom Lake w/300' of shoreline in a private bay with spectacular views of the Palisades and your own private peninsula. Year round access, driveway and cleared building site.
MLS 6076298 - \$97,900

Birch Lake
Appealing 4.15 A lot with private driveway and cleared building site. Over 300' of shoreline on this fabulous lot in the heart of the Gunflint Trail. Can be subdivided.
MLS 6075438 - \$199,000

Lake Superior View

Raven Feather Road
Seriously amazing Lake Superior views, including Alligator Island from the rock outcroppings on this stunning lot. Property consists of 6.65 acres, end of the road location AND abuts Federal land to the west. Close to town & all amenities
MLS 6075126 \$119,900

County Road 67
Check out the Lake Superior views from these properties! 2.7 - 3.48 acres with all utilities readily available - electric, broadband & telephone. DNR owned Lake Superior shoreline across the road so you can have the enjoyment of the lake without the cost.
MLS 6029971 \$69,900
MLS 6029972 \$82,000

Birch Drive
Dream big or dream small--most likely it will involve huge windows facing South! Bordering Cascade State Park, this lot is ready for outdoor activities. Features a partial driveway, 4.9 acres & year round access.
MLS 6075803 \$79,900



County Road 60
Secluded 20 acres located on a County Road with all amenities to include electricity & broadband and is a short drive to town. Lot has excellent views of Lake Superior, abuts State land to the north, close to hiking trails, cross-country ski areas.
MLS 6073592 \$99,900

Gunflint Trail
Year round 6.46A on county maintained road with amazing views of the lake. The cleared path up the property will help you visualize your future home on the North Shore! Also in close proximity to town town, hiking, biking & skiing trails!
MLS 6033168 \$87,500



RED PINE
REALTY

REALTORS®: Mike Raymond, Broker • Gail J. Englund, GRI • Linda Garrity, Realtor
Cathy Hahn, ABR/GRI • Larry Dean, Realtor • Bruce Block, Realtor • Jake Patten, Realtor
Red Pine Realty • (800) 387-9599



(218) 387-9599 • Fax (218) 387-9598 • info@RedPineRealty.com
PO Box 938, 14 S. Broadway, Grand Marais, MN 55604



LAKE SUPERIOR PROPERTIES



PANORAMIC LAKE SUPERIOR. Gorgeous 10 acres with panoramic views on Lake Superior. 545 feet of beautiful sand/gravel beach with a stream running through the property. Located only 1.5 miles from Gooseberry

State Park. Septic hook up is at the road. **MLS# 6031490 \$399,000**

LAKE SUPERIOR, BIG BAY, BIG VIEWS. Dense spruce forest, moss covered boulders and privacy make this a classic Lake Superior lot. 200' shoreline with partial driveway in place, shared road maintenance, power and Broadband. Easy access from Hwy 61, yet private and secluded feeling. **MLS# 6075213 \$189,900**

INLAND WATER PROPERTIES

HERMITAGE OR HERITAGE – LARGE INLAND LAKE RETREAT.

Charming 4-season, 2 bdrm home on 46+ acres with over 1600' beautiful frontage on Two Island Lake. Privacy assured with US Forest surrounding you. Development potential. Located just 20 minutes from Grand Marais. **MLS#: 6075756 \$749,900**



REMODELED DEVIL TRACK HOME.

Like new! 2 bdrm, 2 bath home with all new interior. Many nice features and upgrades including tile and hardwood floors, Marvin windows, wood siding, deck, fixtures, appliances, and more. Two levels, 2 kitchens, incredible lake views! **MLS# 6078755 \$375,000**



PRIVATE LAKESHORE – WILDERNESS LAKE.

Eggers Lake is surrounded by the Superior National Forest and has only one private land owner on its shore. This 160 acre island of private property sits within the scenic and rugged Misquah Hills with remote privacy plus a large wildlife pond. **MLS# 6076498 \$349,900**

QUALITY GARAGE ON WILSON LAKE.

The perfect place for your north woods dream. The Timberland garage is well built and provides an excellent cabin while you build your dream home on a great walleye lake. Knotty pine, wood burning stove, outhouse, and dock with 313' shoreline. Year round access. **MLS# 6078042 \$239,900**



DEVIL TRACK LAKE – REMOTE CABIN.

Quality 2 bdrm cabin featuring lrg windows, cathedral ceiling in the great room, loft, and beautiful kitchen. New well, compliant outhouse. Unique, secluded location with 150 ft frontage in a sheltered bay. 4.78

acres adjoins remote public lands. **MLS# 6078684 \$225,000**



INLAND WATER PROPERTIES

WILDERNESS SETTING - TUCKER LAKE. A perfect place for your cabin or home with unspoiled views and lots of Gunflint Trail privacy. 3.68 acres and 554' shoreline. Tucker Lake is a protected lake with added setbacks to protect the lake and views. Direct BWCAW access. **MLS# 2309237 \$222,900**



CLEARWATER CABIN – PALLISADE VIEWS. This long-owned and loved 2 bdrm cabin is in nice condition and is the perfect simple BWCAW retreat. Warm, cozy wood interior and stunning lake views, just a short hop to the 200

ft of shoreline. Huge dock and 2.30 acres – room to build! **MLS# 6077533 \$212,500**

WILSON LAKE WILDERNESS - FINLAND.

True Solitude! Over 5 acres and 355' shoreline with great build sites near the lake or tucked around the bluff for gorgeous views. Appreciate the stunning sunrises and paddle the bays in a canoe or kayak. Wilson Lake is also a great fishery! **MLS#: 6074552 \$199,500**

CABIN WITH BWCAW VIEW ON MCFARLAND. This super 2 bdrm cabin has great views of the Palisades and the west end of McFarland Lake. Just a stone's throw from the BWCAW! Comes furnished including pontoon boat, fishing boats, canoe, dock, and two Onan generators. **MLS# 6029644 \$199,000**



LEVEL LOTS, NICE WOODS, EASY SHORE.

These Devil Track Lake lots have easy access from a county road, power, phone and great building sites. South shore, 200+ ft. frontage, great views. Build your home on the lake here! **MLS# 6033181, 6078259 - \$198,900 Each**

MARK LAKE - 159 ACRES. The only private land on Mark Lake! Good northern fishing. 200ft. Shoreline, forestry road or snowmobile access. Motivated Seller! **MLS# 6026299 \$197,000**



LOON LAKE GETAWAY. Lovely furnished cabin on pristine Loon Lake. Includes a newer 1 bdrm addition, cozy loft, open living/dining room, sturdy deck, and 24' dock on 142' shoreline. Cabin easily sleeps 6. Lakewater system, septic holding tank. Great lake views! **MLS# 6030355 \$186,000**

PARK-LIKE FOREST – PIKE LAKE.

Mature woods with maple trees makes a beautiful home site on 225' frontage. Driveway, dock and open camp area are in place. Gentle shoreline with nice south facing views across the lake to USFS forest land. Power and year round access. **MLS# 6077393 \$179,900**

RARE GUNFLINT LAKE PARCEL. Exceptional lot with 344' of waterfront features unreal views and privacy. Use the slope of this lot to your advantage when considering what style to build. Power and broadband available. Borders public land! **MLS# 6073686 \$175,000**

VIRGIN PINE, GREAT SHORELINE, PIKE LAKE. Two lake lots with wilderness, woods, and lakeshore are waiting for your dream lake home or cabin. Pristine views, towering white pine, +/- 200' accessible shoreline each with crystal clear water and great privacy. Good driveway in place, ideal location, power and broadband available. **MLS# 6074687, 6074688 \$159,900 each**

NORTH FOWL LAKE CABIN. Only a lucky few get to own cabins here. Remote water access from the US side, or drive in to the landing on Ontario side. Stunning views, easy access to the BWCA.



The 2 bdrm cabin is one of the nicest remote cabins you'll find. Includes a great sauna. **MLS# 6023214 \$149,900**

GREAT GREENWOOD LAKE LOT.

Tremendous views of the bay and lake. 2.10 acres surveyed and ready to build. A true northwoods setting, nicely wooded, privacy, easy lake access. There is a stubbed in driveway and a building pad. Greenwood lake road is plowed in the winter. **MLS# 6076787 \$120,000**

SOLITUDE ON LOON LAKE. These 1-2 acre lots are located on the south side of Loon Lake and offer great lake views, 152-218' beautiful shoreline and many nice trees. The main road is in place and power is on the lot line. **MLS# 6032216-18, 6032220 \$120,000+**

NICE TOM LAKE LOT. Gently sloped 4.34 acre lakeshore lot that would offer some incredible views. Situated in a quiet and peaceful private bay. **MLS# 6076728 \$110,000**

LEGENDARY SAWMILL BAY. Magnificent old-growth cedars and maples frame a corner lot with a high and dry build site. Year-round road access and a terrific wildlife habitat awaits your cabin in the woods. 185' of Caribou Lake frontage. **MLS# 6032953 \$89,000**

TALK ABOUT WILDERNESS! Immerse yourself in a large tract of deep wilderness. 17 acres on Tucker Lake just off the Gunflint Trail. This parcel is tucked up to Superior Nat'l Forest lands with the BWCAW just across the lake. Frontage on the Tucker River, privacy and wilderness all around. **MLS# 6074216 \$69,900**

ESCAPE TO NINEMILE LAKE. Nice, quiet lake between Tofte and Finland known for its recreational opportunities. Very near the BWCAW. Good snowmobile access to the Tomahawk Trail and miles of trail riding. 2.90 acres, 184' frontage. **MLS# 6077701 \$59,900**

PRIVACY AND VIEWS AT SISTER LAKE. Nice lake lot with great forest, and beautiful new building site. There's a high point of the surrounding area with awesome views. Excellent, accessible shoreline. New driveway to a great building site. This is a great area for fishing many lakes in the area. You're also close to Tofte/Lutsen on the North Shore. Priced to sell!!! **MLS# 6073911 \$51,900**

GREAT PRICE LAKE LOTS. Deep woods, seclusion and nice views from these Tom Lake lots. This is the desired west side of the lake with access from the Camp 20 Rd. Enjoy a peaceful lake property with good access. Great back roads to explore. Adjacent land available. **MLS# 6030741, 6030742 \$44,900 each**

PRICE REDUCED! **PRIVATE COVE ON TOM LAKE.** Nice private lot with vibrant, wooded 255' lake shore. Desirable old growth cedar grove supports a great build site. Driveway and cedar walk corridor complete. Great recreational opportunities. **MLS# 6077180 \$46,000**

CONDOMINIUMS

WELCOME TO LAKE SUPERIOR. Warm & beautiful light-filled end unit Aspenwood Townhome. The 2-story walkout style leaves you with plenty of options to get outside and close to the Big Lake. This 2 bdrm, 3 bath home includes 98% of all furnishings & personal property. It is also part of a successful vacation rental pool. **MLS# 6022175 \$280,000**



CARIBOU HIGHLANDS CONDO 113A. This is the epitome of a northwoods vacation get-away. Ski-in/ski-out from this condo overlooking Bridge Run, offering unreal views of the ski hills. Remodeled exterior and remodeled and updated interior. Walk to Lutsen Mountains activities. Comes furnished! **MLS# 6074164**



\$81,700

HOMES & CABINS

A GEM IN THE WOODS. There is quality and detail at every turn in this magnificent 2 bdrm, 2 bath home hidden on 30 acres in the Grand Portage State Forest. Marble stairs and floors, loft, master bath with hot tub & sauna, soaring cathedral ceilings, and 2000 sq ft attached garage. Not your typical home in the woods, this is a rare gem waiting for someone who loves the outdoors, but wants the class of an elegant home at the end of the day. **MLS# 6074633 \$499,000**



HOME WITH DRAMATIC VIEWS. This large, efficient 3bdrm home has panoramic views of Lake Superior and the surrounding hills. Secluded with landscaped yard and 20 acres bordering Gov't lands. Quality features, many windows, shop building and more! **MLS#6033328 \$429,900**



CHARMING HOME NEAR TAIT LAKE. This 2 bdrm, 2 bath cabin is cozied up to a giant beaver pond that is part of the Tait River. Updated through the years but still has the lake cabin charm that is often sought after in the North Shore area. Close to the boat landing and borders public land. **MLS# 6078290 \$304,900**



HOME IN PARADISE. This 2 bdrm, 3 bath home enjoys the view and proximity to Lake Superior's beauty without the lake-front taxes. Home could be converted to a duplex for extra income. Huge garage/workshop with lake-view windows. **MLS# 6074449 \$275,900**



REMOTE HIDE-A-WAY. Charming custom built 2 bdrm, 2 bath cabin tucked in the woods overlooking a beaver pond. A screened porch for summer dining. The living room is open and includes the kitchen and dining. A cozy Franklin stove warms the whole building. The full basement is a complete guest space. Generator power and over 100 acres to explore. **MLS# 6029349 \$244,000**



NEW! COUNTRY LIVING CLOSE TO TOWN. Enjoy country living in a renovated, contemporary, energy efficient 3-4 bedroom home. 1900+ sq. ft. of living space only 10 minutes from Grand Marais. Many quality and custom features. Large 2 car

garage with room for workshop and storage. **MLS#: 6079399 \$239,000**

COTTAGE HOME ACROSS FROM LAKE SUPERIOR. This cute home sits just across the highway from the big lake shoreline. The 2 bdrm, 1 bath cottage has wood floors, beamed ceilings, and a warm, comfortable feel. Septic and well, a small shed and 11 acres of privacy. **MLS# 6030154 \$167,900**



TIMBER FRAMED LOG HOME OVERLOOKING TOM LAKE. Charming log cabin on 78 acres with seasonal views of Tom Lake. Large loft bedroom and covered porch with swing. Stone fireplace, hardwood floors, and metal roof. Year-

round access. Furnishings and generator included. **MLS# 6027412 \$159,900**
COMFORTABLE LOG HOME IN BEAUTIFUL WOODS. This 2 bdrm cabin was set up for a simple lifestyle with solar electric, hand pumped well and composting toilet. Charming living room with stone fireplace, large kitchen and comfortable bedrooms. 12 private acres with mature white pine and cedar. **MLS# 6076755 \$139,900**



CABIN RETREAT NEAR TWO ISLAND LAKE. This sweet off-grid, log sided cabin is in excellent condition with plenty of room and a comfortable feel. Located about 12 miles from Grand Marais.



Public land adjoins the 20 acre property with many fishing opportunities nearby. **MLS# 6073794 \$129,900**
RUSTIC RECREATIONAL CABIN ON 40+ ACRES. Very private recreational 42 acres with rustic cabin and a beautiful, large pond for wildlife. Great grouse hunting and deer hunting. The timber cabin can easily sleep 6 in the loft. Offering to sell furnished! **MLS# 6079154 \$109,900**

HOMES & CABINS

BEAUTIFUL SMALL HOME. This incredible home has all you need in just about 120 sq ft of space. Kitchen, full size bed plus sleeper sofa, storage loft, electric and broadband, fabulous deck, fire pit, shed, and a really cool outhouse. Year round living, close to hiking trails. **MLS# 6077550 \$67,000**



COMMERCIAL PROPERTIES

GREAT HISTORY, GREAT LAKE. Devil Track Cabins is a long standing seasonal resort on the beautiful north shore of Devil Track Lake. The 5 charming cabins + owner's cabin each have a private setting and lake view. Great beach with docking for guests. A wonderful family retreat! **MLS# 6033556, 6033557 \$374,900**



MARKET, DELI, LIQUOR STORE – HOVLAND. A bustling business in a beautiful rural community on the North Shore. Bakery, deli, pizza, convenience store, and liquor store under one roof. Large seating area & outdoor patio. Expansion/home site possible! **MLS# 6030800 \$329,900**



PRIME RETAIL DOWNTOWN GRAND MARAIS. Main traffic location in the heart of down town. Located on Wisconsin St between Blue Water Cafe and Sivertson Gallery, with 25 ft street frontage and over 2300 sq ft each. Build up for a lake view – lots of possibilities! **MLS# 6029930, 6029951 \$144,900 each**
PRIME COMMERCIAL LOTS IN LUTSEN. Two acre-sized lots with Highway 61 frontage-road access and great visibility in downtown Lutsen. Nice creek borders the east property line, nice mature forest. Great location for a small gallery, retail or restaurant. A residential lot is available adjoining to the north. **MLS# 6032971 \$97,900 • MLS# 6032972 \$89,900**

RIVER/CREEK FRONTAGE

LARGE TRACT WITH CREEK. This 319 acre parcel has ponds & creek frontage on the Flute Reed River. Has been in DNR management program. Great for hunting or homesteading. Access is by unimproved easement from the Camp 20 Road, near county maintenance. The land may be split - take your pick of "40's"! **MLS# 6027384 \$258,000**
SUGARBUSH, BEAVER, TROUT. Remote 80 acres ,10 miles from Grand Marais with easy access. Surrounded by public land. 700' of Durfee Creek frontage. **MLS# 6024638 \$149,000**

LOG HOME ON FLUTE REED RIVER. Charming homesteader log cabin with pasture. The river flows beautifully through the property. Private and secluded setting with some high views and heavy timber. The cabin is large and comfortable with a drilled well for carry-in water. **MLS# 6077654 \$132,900**

BRULE RIVER RETREAT. Remote 40 acre parcel with small bunk house, covered camp shelter and outhouse. Walk the path to the river with 660' shoreline where you can launch your canoe and fish this placid stretch. Surrounded by wildlife and thousands of US and State Forest land. **MLS# 6076495 \$99,900**

TWENTY ACRES – GREAT LOCATION. Great larger parcel near Grand Marais with road in to the "top" of the property. Lake views, maple and mixed forest, small creek. County road access with power and broadband close by, borders public land on three sides. **MLS# 6030517 \$89,900**
WOODS, WATER & SECLUSION. Three 40 acre lots with 600 to 1000 ft frontage on Mons Creek. Also includes deeded access to Lost Lake. Private and secluded. **MLS# 6073876 \$59,900 or MLS# 6073877 \$69,900 or MLS# 6073878 \$74,900.**



REALTORS®: Mike Raymond, Broker • Gail J. Englund, GRI • Linda Garrity, Realtor
Cathy Hahn, ABR/GRI • Larry Dean, Realtor • Bruce Block, Realtor • Jake Patten, Realtor

Red Pine Realty • (800) 387-9599



(218) 387-9599 • Fax (218) 387-9598 • info@RedPineRealty.com
PO Box 938, 14 S. Broadway, Grand Marais, MN 55604



RIVER/CREEK FRONTAGE

HIGH PROPERTY, DRIVEWAY, CREEK FRONTAGE. This 25 acre parcel has great southern exposure and views from a nice building site at the end of a long driveway. Very private setting and frontage on Irish Creek. This property is ready for your cabin in the woods, with good solar potential and lots of seclusion. Easy year-round access. **MLS# 6077020 \$69,900**
NICE HOME SITE NEAR GRAND MARAIS. Nice elevation and views from this 6.75 acre lot off of County Rd 6 just minutes from town. Frontage on Little Devil Track River, with lowland and highlands. Nice forest and privacy for your home or cabin in the woods. **MLS# 6031740 \$51,000**
FLUTE REED RIVER HOME SITES. These two heavily wooded parcels have the seclusion of 11-13 acres and about 330' frontage each on the trout stream Flute Reed River. Access is easy from frontage on a county road. Power and broadband are available. These lots are the perfect place for a retreat property or a year-round home. **MLS# 6030884, 6030885 \$49,900 each**
500' ON MOHNS CREEK. Mixed topography of beautiful rolling land with many great build sites on 25 acres. Old growth cedar, spruce, pine and birch. Abuts state land. **MLS# 6029353 \$37,000**

LAND/BUILDING SITES

100+ ACRES NEAR GRAND MARAIS. Great location for a home or recreational property just minutes from Grand Marais. Rolling land with creek, borders thousands of acres of federal and state lands. Power at road. Seller willing to subdivide. **MLS# 6032474 \$277,900**
LOCATION, VIEWS, PRIVACY - 80 ACRES. This former homesteaders property has it all: rolling topography, ravines, grassy meadows, mature timber, flowing creek and expansive Lake Superior views! Minutes from Grand Marais, adjoins USFS land. **MLS# 6076511 \$279,000**
TOP OF BIRCH CLIFF. See 50 miles across Lake Superior - incredible 180 degree views! Private drive and buried power in place. 15+ acres with nice mature trees and public lands on 2 sides. More land is available. This site will rock your world. **MLS# 6033563 \$249,900**
BEAUTIFUL LAND, TUCKED AWAY PRIVACY, LOG CABIN AND POLE BARN. This 36 acre parcel is tucked up against the "Hovland mountain range" with mature forest, easy road access and a moderated Lake Superior climate. Charming log cabin/home plus lrg 34' X 56 pole building. Build a future home amongst the pines and with a lake view. Property can be split, utilities are nearby. **MLS# 6076757 \$229,800**
ACREAGE ADJOINS WILDERNESS - LAKE ACCESS. This 42 acre parcel includes 400 feet of shoreline on McFarland Lake. Building sites are located across the road on the hillside with potential lake views. Easy access to the BWCAW and Border Route Hiking Trail. **MLS# 6024602 \$179,000**
INCREASINGLY RARE, LARGE RECREATIONAL PARCEL. 190 acres fully surveyed. The perfect retreat. Has a rich variety of trees, ponds, high and low lands, some meadow land and wetlands. **MLS# 6029820 \$139,000**
PROVEN GREAT HUNTING AREA - 80 ACRES. Prime hunting land in Schroeder. Rolling land with great wildlife habitat incl. stream, beaver dam with large pond, and a good mixture of trees and low vegetation. Older 2 bdrm cabin in a beautiful park like setting overlooking large beaver pond. **MLS# 6032712 \$112,500**
LARGE ACREAGE NEAR TOM LAKE. 128 acres with good road access and an easy walk to the Tom Lake boat landing. Year-round road, power is possible here. The 3 forties may be split - take your pick. **MLS# 6027383 \$111,000**
TWO INCREDIBLE LUTSEN PARCELS. Driveway, electric/broadband, survey and a cozy camper/RV are all set on Lot 3, while Lot 4 offers unending privacy as it abuts federal land. Christine Lake public boat landing is within walking distance with Poplar and Tait rivers nearby as well. **MLS# 6032903 \$89,000**

LAND/BUILDING SITES

HUGE POND-HUGE PRIVACY. Large 45+ acre wooded parcel located across from Tom Lake. Huge pond/lake in the very center of the acreage. **MLS# 6029352 \$90,000**
LARGE UNDEVELOPED CITY TRACT. This large Central Addition property is perfect for a lot development plan, or as a private home site. City utilities are close, street access on two sides. Many possibilities. **MLS# 6076673 \$89,900**
LARGE LAND, PINES, PRIVACY AND PIKE LAKE VIEW. Outstanding property with adjoining USFS lands, good access on Murmur Creek Rd, and even nice views of Pike Lake. Launch your boat just a half-mile away. Nice planted red pine, power/broadband close by. **MLS# 6074689 \$84,900**
NEW! RESORT COMMERCIAL/RESIDENTIAL LOT - TOFTE. This 8.64 acre parcel has over 900 feet of Highway 61 frontage with great visibility. Utilities are on the lot. Lake Superior views. If you have a lodging idea in mind this might be the perfect spot. Great location between Tofte and Lutsen. The bike trail is just across the highway. **MLS# 6079287 \$82,900**
LAND NEAR WILSON LAKE. A special piece of the Northwoods - 16 acres with deeded access to Wilson Lake! USA-owned forest is your backyard. Driveway, electric, and a small bunkhouse/shed are in place. **MLS# 6028685 \$80,000**
HIDDEN GEM IN HOVLAND. Explore the 40 acres of seclusion with dramatic views from the south facing bluff. Enjoy the beautiful mixed forest and abundant wildlife. It even has a small gravel pit for your future building needs. The neighbors have electricity and the road has been kept open all winter through a road association. **MLS# 6076192 \$75,000**
FORTY WITH PONDS - COUNTY RD FRONTAGE. This 40 acre parcel has beaver ponds, adjoining federal land and easy access with frontage on County Rd 14. Just 15 minutes from Grand Marais, this would be a great large home parcel, or rec land with 1000s of acres of USFS lands on the west border. **MLS# 6076727 \$69,900**
NEW! GREAT BUILDING LOT NEAR TOFTE. This 5.82 acre parcel has privacy, adjoins US Forest land and has Lake Superior views. Utilities are at the lot. It's also zoned Resort Commercial if you have a lodging idea in mind this might be the perfect location. Great location between Tofte and Lutsen. The bike trail is just across the highway. **MLS# 6079285 \$66,900**
GREAT BUILDING LOT NEAR TOFTE. This 5.82 acre parcel has privacy, adjoins US Forest land and has Lake Superior views. Utilities are at the lot. It's also zoned Resort Commercial if you have a lodging idea in mind this might be the perfect location. Great location between Tofte and Lutsen. The bike trail is just across the highway. **MLS# 6079285 \$66,900**
LARGE LAND, POND, LAKE RIGHTS. Densely wooded 60 acre parcel with beaver ponds and access to Lost Lake. Good seasonal road access, many great building sites and southerly exposure. Lots of elbow room, privacy, and miles of forest roads to explore. **MLS# 6033463 \$63,900**
GREAT LOCATION FOR YOUR HOME. 7.5 acres located just 5 miles from Grand Marais on County Rd 7 blacktop. Some lake views, good building sites, driveway and a tiny cabin set up for your camp outs until you build. **MLS# 6078360 \$64,900**
ROLLING LAND, PINES, HOME SITES. Two 10 acre parcels of heavily wooded land within 10 minutes of Grand Marais. Great location with remote feel near trails and thousands of acres of Federal land, yet close to town and the big lake. County road with utilities. **MLS# 6076524, 6076539 \$62,900 - \$64,900**
LARGE LAND, MAPLES, LAKE ACCESS. This 67 acre parcel has high maple ridges, a pond, and an easement to walk to Tom Lake. Good seasonal road access, many nice building sites. A perfect escape property in an area with many trails to ride and forest to explore. **MLS# 6030705 \$62,900 PRICE REDUCED!**

NEW! WOODED SECLUSION IN GRAND MARAIS. Six great wooded lots on the west side of Grand Marais. Build your home within a short distance of the bike trail and just a mile to downtown. Septic systems and wells are allowed here with power and broadband. Privacy on a dead end road. **MLS#: 6079335-40 \$49,500 - 59,500**
SUNNY 5 ACRES NEAR GRAND MARAIS. Beautiful sunny hillside with distant Lake Superior views. This is country living only 2 miles from Grand Marais. Large lot, great home sites with abundant wildlife. Driveway partially in place. **MLS# 6077083 \$54,900**
DEEP WOODS NEAR GRAND MARAIS. Two 5+ acre lots adjoining USFS land with power/phone/broadband. Great location near Grand Marais with good road access and very secluded location with mature trees. Ready for you to build your country home. First time on the market. **MLS# 6076518/6076517 \$49,900 - \$52,900**
LAND FOR FUN OR HOMESTEADING. Heavily wooded 39 acres with a large variety of trees and easy road access on Camp 20 Rd. Southern exposure great for solar set up. The Superior Hiking Trail is steps away. Close to county maintained road. **MLS#: 6075981 \$48,900**
NICE 20 WITH BEAVER POND. The driveway and trails are in place on this nice 20 acre parcel with maples, cedar and variety of forest types. Large beaver pond adds a water feature for wildlife! **MLS# 6077902 \$45,900**
MAPLES ON SECLUDED 20 ACRES. This mature maple forest is enchanted and full of neat places to build a home or cabin. Rough driveway was put in years back. Trails lead to public lands. Good road access. **MLS# 6077903 \$45,900**
BUILDING SITE OVERLOOKING MCFARLAND. This pine studded 7 acre property has easy walking access to the county beach on McFarland Lake. Nice elevated build site with easy county road access. **MLS# 6024601 \$43,000**
GREAT LOCATION HOME SITES. Just minutes from Grand Marais on black top County Rd 7 are two 5+ acre lots with easy access to power and Broadband. Good building sites. **MLS# 6079612 - \$42,900 • MLS# 6079615 - \$64,900**
NEW! 20 ACRES OF RECREATIONAL PARADISE. Nice parcel bordered by state lands. Perfect for hunters and set up with trailer, shed, and outhouse. Just a short hike to the Greenwood Lake Helipad (1/2 mile) overlooking the magnificent lake. Have a picnic and a great day. **MLS#: 6079410 \$39,500**
BEAUTIFUL WOODED LUTSEN LOT. Beautiful level lot with an open build site for your cabin or new home in a quiet and peaceful area of Lutsen. You'll be minutes away from every type of north-woods activity, including Lutsen Mountains and Superior National Golf Course. **MLS# 6033068 \$32,900**
5 ACRES NEAR CARIBOU LAKE. Gorgeous corner lot with colorful maples and majestic cedars. Plenty of privacy. Close to hiking trails and the Caribou Lake boat landing. Year round access with power! **MLS# 2279179 \$35,000**
LAND FOR ESCAPE AND RECREATION. remote yet accessible 20 acres near Judge Magney State Park. Good mix of trees, high building site, some distant Lake Superior views. **MLS# 6025397 \$33,900**
GREAT LOCATION HOME SITE. Wooded home or cabin site near Devil Track Lake. The 1.72 acre lot has nice trees and maybe a view of the lake from a second story. The boat landing is just down the road, as are many other lakes and trails. **MLS# 6029872 \$33,000**
REMOTE SECLUSION/HUNTING LAND. Forty acres of remote seclusion with Flute Reed River frontage. Good hunting area. Rough access, but walk or ATV. Adjoins State land to the north, with thousands of acres of USFS lands north of that. Want privacy? Here it is! **MLS#: 6075271 \$29,900**



Lutsen Real Estate Group

Office 218-663-7971

lutsenrealestategroup.com

Meet Our
Awesome Agents!



Sandy McHugh
218-370-7841



Jack McHugh
218-370-2602



Mike Larson
218-370-1536



Frank Lehto
218-387-4955



Bruce Kerfoot
218-388-2294



Steve Surbaugh
218-663-7971



Grand Marais Area Homes



166 Bloomquist Mountain Rd. Quality-built, classic chalet-style home on a private 6+ acre wooded setting. Has the feel of an “off-grid” estate yet complemented with expected features including broadband. Only minutes from town! Italian porcelain tile and solid oak flooring throughout. Significant new improvements include - road with smooth layer of gravel over crushed rock and new culverts, freshly painted interior and new deck stain. **MLS 6073816 \$239,500 Call today for a showing!**



Just West of Grand Marais. Nicely appointed and extremely well maintained beautiful 3 bedroom home just west of Grand Marais. Home includes a two stall garage with adjacent office, workshop, wine room and more. Many wonderful upgrades made to home in 2010. Nice clean yard and garden areas. Move in ready. All you need is the key. Call our office today to schedule your private showing. **MLS 6029508 \$329,900**



44 Caspers Hill Rd. Peaceful country home w/ 3 bdrms, 3 baths & 3 gorgeous stone fireplaces. Eat-in kitchen has a wood-burning fireplace to warm those winter nights. Huge master bedroom with a stone fireplace and whirlpool tub. Upper level includes loft family room, office and large bedroom with dormers. Walkout LL has Fam room & bathroom. Exterior includes cedar-shingled roof, deck, detached dbl garage w/loft bunk rm, circle driveway & 5 acres. Located on a county-maintained road with close proximity to Grand Marais for work or leisure activities. **MLS 6078471 \$269,900**



Kelly's Hill. Very nice and well-kept 2 bedroom 2 bath home on nearly five acres just east of Grand Marais. Private trails cut on land with the Superior Hiking trail nearby. Yard and large garden areas surrounded by mature forest and some wonderful large White Pine trees. Beautiful sunrise and sunsets with Lake Superior views from the second level master bedroom and deck. **MLS 6077096 \$219,900**

Area Inland Lakes

Pike Lake – 19 Summer Home Ln. Iconic, up-north log-sided cabin on Pike Lake in a gorgeous, park-like setting! Knotty pine interior, 2 bdrm & open concept kitchen, LR/DR, plus 3-season porch w/Doug fir floor & 2 decks. Heated bunkhouse & bathhouse w/compliant outhouse. Level, accessible shoreline, plus future garage site already in place. Elec & Broadband installed. Make this cabin your new home away from home on one of the cleanest lakes in MN. **MLS 6078470 \$234,900**



Area Homes & Townhomes



Lutsen Heritage Townhome with Superior Views Panoramic views of Lake Superior & Lutsen Mountains can be enjoyed from nearly every room. High end finishes, including maple woodwork, stainless appliances, granite counters, Mission-style raised panel doors, and two gas fireplaces with dry-stacked stone. Maintenance-free living and part of a distinctive neighborhood. Main floor bedroom allows one-level living. Has successfully been offered as a vacation rental, helping to offset the cost of ownership. For the right price, furnishings included with sale, allowing turn-key use and/or rental. Proximity to many activities & venues, including Lutsen Ski Hill, North Shore Winery, Superior Hiking Trail, restaurants and shops. Call today! **MLS 6077102 \$315,000**

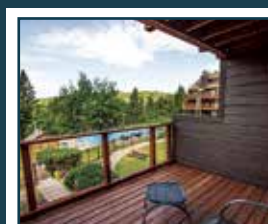

104 C Bridge Run Ln. Nicely remodeled Nordic whirlpool studio condo at Caribou Highlands ski-in ski-out resort in Lutsen. With many amenities at the resort as well as hiking and biking trails on the ski hill, you won't have a lack of options during the day. Enjoy relaxing on the new deck overlooking Moose Mountain, with distant views of Lake Superior. With new siding, roof and deck all part of the updates in the past few years this Nordic studio is not one to overlook! **MLS 6077413 \$69,000**



562 Poplar River Road
562 Poplar River Road – **MLS 6075178 \$379,000**



582 Poplar River Road – **MLS 6078045 \$339,000**

Experience North Shore resort living at its finest. This luxurious 3 bedroom, 3 bath, 3 fireplace Poplar River condominium is part of the historic Lutsen Resort on Lake Superior. Excellent track record of rental income due to high demand for units like this with amazing views. Enjoy all of the comforts and amenities of the resort including fine dining, swimming pool, and daily resort activities. Walk the trails to enjoy an evening bonfire on the beach, or just enjoy the beautiful scenery along the Poplar River. Just minutes from Superior National Golf course and Lutsen Mountains ski hill.



11 Jonvick Creek Ridge, Lutsen. First time on market, custom-designed, cedar-sided 2+ bedroom home in a wooded setting with Jonvick Creek and Lake Superior views! Quality throughout: rich Eastern Pine tongue and groove walls and ceilings, birch kitchen cabinets; open concept between kitchen, dining and living rooms. Wood burning fireplace lends a cozy feel to this home, and you'll love the convenience of a main floor master bedroom, office, laundry and attached garage. Huge loft area features a second bedroom and ample room for another sleeping area. Downstairs there's a full unfinished basement with in-floor heat waiting for your design plans - with egress windows, you can choose to add 2 bedrooms and there's still plenty of room for a large family room! Wander through the lush lupine meadows to your expansive garden area, surrounded by native raspberry bushes. This home is located minutes away from cross-country ski trails, Superior National golf course and Lutsen Mountains! **MLS 6077908 \$369,900**



EARN MONEY WHEN YOU ARE AWAY BY PLACING YOUR HOME IN OUR VACATION RENTAL PROGRAM. Give Andrew a call at 218-663-7971

When you visit our website www.lutsenrealestategroup.com you will find additional information on all properties in the area accompanied by multiple photographs for a more comprehensive overview of properties you may be interested in.



**Lutsen
Real Estate
Group**

Using a fundamental business approach for all
your real estate needs

Office 218-663-7971

lutsenrealestategroup.com



WE HAVE SOMETHING FOR EVERYONE

Gunflint Trail Area

Lakeshore lot on Poplar Lake with a new 2 stall garage, electric, driveway, nicely wooded, great views to the north and west, 200' lake frontage, 1.8 acres, on a private road with year around access.
MLS 6074074 \$158,000

1 Bedroom log cabin on Gunflint Lake, 306' of lake frontage, 5.3 acres, approved septic permit, electricity, 3 Season, \$229,000

Pancore Lake/Tofte



Trout fishing paradise found!
60 acres and 250' pristine lakeshore on a clean, deep, DNR managed trout lake. Rare find, one of only 3 privately owned parcels on the lake.
MLS 6028959 \$195,400

Lake Superior Vacant Parcels and Homes



Stonegate in Hovland. Looking to build on beautiful Lake Superior? Check out this lot and all it has to offer. With septic already installed, electric to build site, driveway and cleared build-site, and an accessible cobblestone shoreline, this lot is ready for a home! The build-site is complemented with additional and nicely forested property and a very cool creek to hang out by. A great spot to build a guest home or studio. With both Lake Superior and a creek, this lot is simply waiting for the perfect home and homeowner. And a great bonus – the property is 5.4 acres with 200' of shoreline. In addition, the property is located on the quiet road of Stonegate – distanced from Hwy 61.
MLS 6076045 \$249,000



Rosebush Lane near Grand Marais. Thinking of building your Lake Superior dream home and want to be close to all that Grand Marais has to offer? Look no further! West Rosebush Lane extends onto a point giving you seclusion and buffer from highway noise that you want - and is so close to Grand Marais you might want to walk to town! Add to the convenient location the amazing panoramic views of the big lake with sunrise and sunset viewing. Watch 4th of July fireworks lighting the sky over Artist's Point from your sprawling ledgerock beach! Not many lots left like this one. Electric and broadband available at the edge of the property.
MLS 6074324 \$325,000

Other Vacant Land Parcels



Lund Road off Honeymoon Trail. Looking for a peaceful spot close to some lakes? This 5+ acres is tucked 15 min from downtown Lutsen, close to Christine Lake, White Pine Lake and Tait River, a great location for exploring the lakes and woods while still being close to the ski hill. A great quality on this land is gravel! Since the gravel is already on the property it can be used for the driveway, site prep and other. No hauling required! MLS 6075805 \$45,900

xxx 342 Rd Finland. Large parcel covered in Maples, Birch, and other mixed forest. Can be sold as parcels. No gravel mining for 10 years from date of purchase. **160 acres**
MLS 1968744 Price \$299,000

Murmur Creek Near Pike Lake. Have you ever wanted your very own 20 acres in a remote, peaceful place with a diverse forest and absolute privacy? Look no further than this sweet spot. Beautiful parcel with building and septic sites located. Call for specific directions for finding this pristine and secluded forested property. **MLS 6076404 \$35,000 PRICE REDUCED**

Mountain Ash Lane. Cedar covered hillside overlooking Lake Superior in Lutsen. Roads and survey completed for small subdivision. Perfect opportunity to own large acreage in Lutsen overlooking Lake Superior or develop a small subdivision. Final plat not recorded. 30.89 acres.
MLS 1600605 Price \$649,000



9480 Hwy 61 Unique 4 bedroom, 2 bath Dome home on Lake Superior near Schroeder. Outstanding lake views with useable and accessible shoreline allowing for kayak and other access on calm days. Bonus two-car garage near main home entry and an additional detached deck near the lake for any kind of occasion.
MLS 6076429 \$449,999

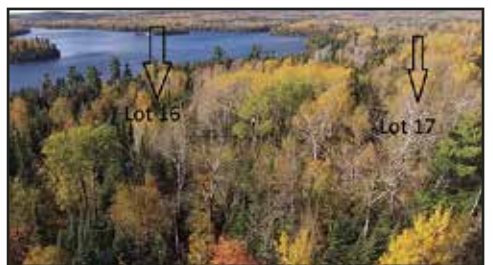

Tait Lake, Lutsen. Recent sales of undeveloped lakeshore lots show prices exceeding \$200,000. Lots 16 and 17 have the benefit of Tait Lake access without lakeshore prices. Tucked hillside overlooking Tait Lake on Caps Trail, Lot 16 offers 2.8 acres with convenient and deeded access to the association's private dock. Lot 17 provides the same with 3.3 acres. Beautiful, wild and unspoiled and simply outstanding values.
Lot 16. **MLS 2143246 \$49,499**
Lot 17. **MLS 6032087 \$54,499**



Gorgeous Chateau LeVeaux Condo Quality finishes along with tasteful new furnishings make this an ideal choice for anyone's North Shore getaway. Open concept layout, with a high-end look and those ever-changing moods of Lake Superior. Walk-out to a private patio to watch the sunrise. Or take in the morning views of the big lake tucked into your cozy bed. Plus a wood-burning fireplace for those chilly nights. Chateau LeVeaux comes with many amenities, including pool, whirlpool, sauna, and their spectacular common deck for those big sky views. Tofte is close to all the action on the shore, including the ski hill, hiking trails, golf, and great restaurants & cool music. This one is not to be missed! Showing appointments being taken now. **MLS 6078779 \$76,000**

Superior National Golf Course Homesites



Few Golf Courses have been built on land as spectacular as Superior National. And more recently the golf course just completed its nearly \$4.5 million course improvement project on the River and Canyon Nines. The homesites listed below are tucked within the Cedar Forest along River 6 fairway and River 6 green. With water, sewer, power and broadband available, combined the sounds of the Poplar River just across the fairway and so much more beauty, the value offered simply is unbelievable. Act now, the golf course will launch its new marketing campaign in 2018 announcing the grand-re-opening – with that, lot prices will likely increase next year.

Lot 4 Block 2. This lot sits adjacent to #4 fairway on River 9 at Superior National Golf Course. Very nice build site with easy access from Ski Hill Road. Water, Sewer, power and broadband available curbside. This is an excellent value. **\$59,900**

Jonvick Creek Sites in Lutsen



Winding through the Sawtooth Mountain highlands, the private road takes you through a mature maple forest: you have found your new homesite nestled in the hills, overlooking a trout stream with views of Lake Superior. Build the home of your dreams in the woodland paradise, only minutes from everything Lutsen has to offer; connect with a network of groomed cross-country ski trails, or set off on a snowmobile adventure on the adjacent trail system. Deer, fox, lynx and maybe the occasional moose will be your neighbors visiting your backyard. Several lots to choose from, ready for you to plan your Lutsen getaway home.

Our featured Jonvick Creek lot is Lot 41—beautiful red maples on a rolling and wooded 2.65 acre lot. This parcel includes pond frontage and possible seasonal Lake Superior views. **MLS 1599050 \$54,900**

EARN MONEY WHEN YOU ARE AWAY BY PLACING YOUR HOME IN OUR VACATION RENTAL PROGRAM. Give Andrew a call at 218-663-7971



**Early Snow Makes for a FUN December!
Head North before the Holiday Stress!**

**Call TimberWolf for Your
Personal Tour of Homes & Land!!!
Local 663-8777 •
Toll free (877) 664-8777**

Info@TimberWolfRealty.com

LAKE SUPERIOR LIVING, MAKE YOUR DREAMS COME TRUE!

**NEW! LUTSEN'S
CASCADE BEACH
RD AUTHENTIC
LAKE CABIN!**

236+ft of shoreline highlighted by a sprawling ledge rock point that juts out from the mainland in the shape of a giant fish hook, forming a natural cove. 1939 cabin built on exceptional lakeshore, with Superior's breakers crashing on the massive ledge rock. The original cabin is now a four season home: warm woodwork throughout, a two story cobble stone (from the cove) fireplace for the ages. Two private and



restful bedrooms, a loft with 2 twin beds overlooking the light filled living room, which host the views of Gitche Gumee's shining big sea waters. Two bathrooms! The kitchen looks down on all the moods of the Big Lake, with corner windows, a simple charm of the way kitchens were back in the day. Two-car, extra big garage boasts a large deck, a workshop and bunkroom for overflow guests, or make it your office/studio.
**MLS#6079179
\$670,000**



**DREAMING
ON THE
NORTH
SHORE!**

Overlooking BlueFin Bay on Lake Superior, this Tofte home has Amazing Lake Superior views! Top Notch Construction, with thoughtful design centered around family gatherings and individual

spaces. Gourmet kitchen which will satisfy the fussiest chef, with kitchen island and breakfast bar. Wall of windows face Lake Superior, really fantastic interior spaces focused on the Big Lake. Master loft bedroom with nice views. Lower level bedrooms with rec space, your guests will love their own space, with Lake Views too! Large garage with guest space above. Gorgeous land, Gorgeous home.

**MLS#6076479
REDUCED! \$549,000**



COMMERCIAL ON THE NORTH SHORE!



LOW MAINTENANCE RENTAL INVESTMENT OPPORTUNITY! Enjoy solid long term rentals, self-sustaining solid local businesses. Highway frontage and Room to Expand Up! Support the Local Economy and Enjoy some passive income, Buy Now and bring your ideas for expansion!

MLS#6028366 \$324,900 REDUCED!

NEW! COMMERCIAL LAND ON THE CROSS RIVER IN SCHROEDER!
Former Site of the Cross River Café! Lots of Opportunities, River Frontage and Established site.
MLS#6078629 \$72,000



**PEACE AND
SOLITUDE AT
A MAXIMUM
ON LUTSEN'S
LAKE
SUPERIOR!**

Simple and Solid Lake Superior Cottage. located on Lutsen's Cascade Beach Road, All the folks that don't like to hear the highway, this is the place for you! No sounds but the waves rolling up the sprawling ledgerock shoreline. A very unique and incredible piece of land and lakeshore, the long tree lined driveway opens up to an expansive

view of Lake Superior, with the cottage centered in the middle of the nearly 200 ft of shoreline, with 3.4 acres of land! The cottage is all that you need, two bedrooms, a nice large bathroom, living room with fireplace and a walk through galley style kitchen. Well maintained, new roof, new furnace, and a cozy fireplace...it's a very warm and inviting space ready for you to enjoy!

**MLS#6079647
\$575,000**



CHECK US OUT ON FACEBOOK AND LIKE TIMBERWOLFF REALTY!



**Early Snow Makes for a FUN December!
Head North before the Holiday Stress!**

**Call TimberWolf for Your
Personal Tour of Homes & Land!!!
Local 663-8777 •
Toll free (877) 664-8777**

Info@TimberWolfRealty.com

WILDERNESS LAKESHORE, FOUR SEASONS OF REST & RELAXATION!



SERENITY NOW AT TAIT LAKE!

Comfortable family lake cabin in Lutsen, on some Sweet Swimming shoreline! 3 bedrooms, full bath, and two half baths! Awesome screened porch, nice family room open to kitchen, great entertaining space! Oversized for boat storage 2 car detached garage! Move in Ready with a Civilized sense of seclusion!
MLS#6073605 \$345,000 REDUCED!



NEW! ADVENTUROUS FOLK WELCOME! 950+ FEET on West Twin Lake, easy summer access and FUN winter access! Stylish Log Home with beautiful views of peaceful West Twin Lake, located 12ish miles off the Gunflint Trail at the South Brule River. Great sense of Serenity, this home was well built in 2002 and functionally designed. Vaulted ceilings, wood fireplace, skylights, natural wood throughout, all finely crafted. Big lakeside deck, year round dock. Located near-by to snowmobile trail for easy winter access. Electric and fiber optic is at the cabin.
MLS#6078598 \$299,900



DESIGN AND ELEGANCE ON DEERYARD LAKE, LUTSEN.

Lindal Cedar Home, dramatic stone fireplace set amongst posts & beams of Douglas Fir. Designer kitchen, sunroom, secluded master bedroom and bath with soaker tub. Wood fired oven, Timberframe Sauna, Woodshop and a large garage. End of the Road 4.48 acres, 175' of frontage, adjacent public land buffers and beckons. Leave Everything behind and just enjoy the Good Life on Deeryard Lake!
MLS#6028689 \$579,000 REDUCED!



MOUNTAIN RESORT HOMES AND LAKE SUPERIOR VACATION RETREATS



SIMPLICITY OVERLOOKING MOOSE MOUNTAIN! Lutsen Mountain Ski and Summer Resort, if you love Lutsen Vacations, then these Condos and Townhomes are for you! Use as often as you like and make money when you aren't here! "Hands off or on Ownership" means flexibility for keeping all to yourself for family and friends, or choose a management company that will fit your needs. Some are newly renovated exterior and out, some are not. From Studios (with huge decks) to 3+ bedrms, See them all to find YOUR right fit!

108 BRIDGE RUN \$89,900 MLS#6027475

124B BRIDGE RUN \$99,900 MLS#6032522

114 BRIDGE RUN \$109,999 MLS#6028015

128 BRIDGE RUN \$111,900 MLS#2120739

120A BRIDGE RUN \$109,000

BIG VALUE! MLS#6074478

670 MOOSE MOUNTAIN TOWNHOME! \$338,000 TONS OF VALUE!

MLS#6077716 REDUCED!



UNIT 1 AT BLUEFIN BAY RESORT!

Excellent Vacation getaway on the North Shore, this 2 bedroom Condo has modern design with vaulted ceilings and TONS of Lake Superior views, just a stone's throw to Lake Superior! Super rental revenues, excellent amenities!

MLS#6077000 \$349,900



BEST OF THE HIGHLANDS! This Lutsen Mountains Ski In/Out Condo was renovated from top to bottom, Inside & Out! New Exterior- windows, slider doors in bedrm and family room, stylish dry-stacked stone fireplace. INCREDIBLE Cottage Style Kitchen w/ Quartz Countertops! Moose Mtn Views from the HUGE double sized deck!

MLS#6032522 \$99,900



ASPENWOOD ON LAKE SUPERIOR, EXPANSIVE VIEWS!

Upper level incredible master bedroom en suite, huge Views of Lake Superior from Bathtub and King Bed! Fantastic Layout, Stylish Living on Lake Superior with little maintenance! Gourmet kitchen, dining area, Step Down to the Great Room with fireplace and Fantastic Lake views!

MLS#603110 \$309,900

CHECK US OUT ON FACEBOOK AND LIKE TIMBERWOLFF REALTY!



**Early Snow Makes for a FUN December!
Head North before the Holiday Stress!**

Info@TimberWolffRealty.com

**Call TimberWolff for Your
Personal Tour of Homes & Land!!!
Local 663-8777 •
Toll free (877) 664-8777**

NORTHWOODS HOMES AND CABINS, IN TOWN OR IN THE WOODS!



FAMILY FUN IN SILVER BAY!

Large family kitchen will WOW you, three main level bedrooms and bath, and lower level rec room/bath/bunk space allows for plenty of elbow room! 2 car detached on a spectacular Hays Circle lot! You'll LOVE the backyard patio! **MLS#6075984 \$155,900
REDUCED, BIG VALUE!**



NEW! WELCOME TO THE

NORTHWOODS! Located 20 minutes from Lake Superior and the Cross River in Schroeder, this Finland home is all about Family Fun! Open kitchen to dining area overlooking a Maple Forest, Large family room with fireplace, sun room nook, and Great Views! Lower level two bedrooms and a master en suite bath, tons of Family Space! Includes Mint Bunkhouse, and Barrel Sauna. Wowser of a home!
MLS#6079618 \$223,000



**HAND CRAFTED ON THE
HONEYMOON TRAIL!**

Shake off your worries as you pull up to this beauty of a home! Unload and Enjoy the Peaceful Oasis this wilderness home offers. Bordering Superior National Forest AND State Forest to Christine Lake in Lutsen. Hike the "Portage" to Christine, or trailer the boat to a MULTITUDE of excellent fishing lakes within 10 minutes. Sounds like it's in the middle of NO WHERE, correct? NOT SO! This gem is only 12 miles to downtown Lutsen; with year round access and fiber optic/electric. And when you see the Hand Crafted Log home with updated kitchen, remodeled bathrooms and really great design, you'll fall in love. This home WILL NOT DISAPPOINT. Year Round recreation from your front door, Gotta love it. 2 PLUS car garage.
MLS#6078599 \$399,900



**LOG STYLE LIVING
OVERLOOKING
LAKE SUPERIOR!
MLS#6078495
\$359,900**



SIMPLY MODERN RUSTIC STYLE!

Lutsen cabin is a MUST SEE if you enjoy the simple things in Life! Two bedrooms, open kitchen/dining spaces, covered porch area and a sauna house! No well nor septic, but there's an Outhouse! Must see to appreciate.

MLS#6076115 \$132,000 REDUCED!



**SWEET TOFTE LOCATION,
ESTABLISHED BUILD SITE!**

MLS#6074783 \$54,500 NEW PRICE!



LUTSEN-TOFTE AREA HOME!

Come take a Look at this Tofte home with acreage! Lots to offer, the home is solid and has a nice flow. The kitchen has been upgraded! Large windows allow for lots of light, and accessory buildings are perfect for a workshop and garage! Curious? Give us a call to see this gem!
MLS#6022904 \$177,500

**JUST EAST OF
GRAND MARAIS,
JEFFREY LANE
HOME!**

Lots of square footage for the money! Solid home, Good well and septic, GORGEOUS piece of land. The home needs a little TLC but has Great Living space upstairs with incredible views from the deck!

**MLS#6078550
\$189,900**



**NEW!
HUMPHREY
CIRCLE HOME
IN GRAND
MARAIS!**

Newer SIP energy efficient construction, and fun layout! Wooded land envelopes this 3 bedrm 2 bath home that has some finishing left to do. Light flows throughout the home, bright and sunny!

**MLS#6078699
\$239,000**



**COME ON! AREN'T YOU A LITTLE
TIRED OF SLEEPING IN A TENT?**

Very near the public access to Gunflint Lake, these Rustic cabins are CUTE, with Log sauna (needs a wood stove). Don't worry, we aren't talking 4 Star Accommodations, it's STILL a Camp near Gunflint Lake Up the Trail! A Must See for the Adventurous!
MLS#6076146 \$129,900

**RUSTIC LIVING A HOP SKIP &
A JUMP FROM GRAND MARIAS!**

Charming rustic cabin on 10 acres of south facing forest with distant views of Lake Superior. Bordering public lands, great for hunting or hiking!
MLS#6020031 \$85,500 REDUCED!

Call TIMBERWOLFF REALTY or visit www.timberwolffrealty.com for more information!



**Early Snow Makes for a FUN December!
Head North before the Holiday Stress!**

Info@TimberWolffRealty.com

**Call TimberWolff for Your
Personal Tour of Homes & Land!!!**
Local 663-8777 •
Toll free (877) 664-8777

CAMPN', HUNTN', FUN GETAWAY LAND, INVEST IN YOUR FUTURE!

SILVER BAY TO FINLAND	SCHROEDER AND TOFTE AREAS	LUTSEN AREA	LUTSEN AREA
ROCKY WALL outskirts of Silver Bay! Huge Lake Superior Views, Driveway and Campsite in Place! Maple Forest, Electric, Developed Build Site! \$99,900 MLS#6074084	feel with year round access, great build sites! MLS#2070509 Prices from \$24,900!!	10 ac site, minutes to Lutsen Mtn's. \$62,500 MLS#6077523	Ridgetop 5+ ac in Lutsen, Fantastic location, minutes to the Ski Hill, Yr Round Living with some Lake Superior Views, perfect for 2 story walk out home. MLS# 603266 \$49,900 REDUCED!
Whitetail Ridge Overlooking Lake Superior! Just off Highway 1, Enjoy Sprawling Lake and Ridgeline views and Rugged Terrain! Yr Round Access, Electric. MLS# 6024856 \$95,000 REDUCED!	Wowser Lake Superior views on Overlook Tr! MLS#2296509 \$79,900	Woodland Foothills Build Ready lots, Shared Water & Community Septic from MLS#2309328+ FROM \$39,000	Boreal Lane at the Foothills of Lutsen Mountain Ski Resort 5 ac lot, great location! MLS#6023557 \$65,000 PENDING
30 acres Wilderness, Borders lands next to Little Manitou River! MLS#2309327 \$129,000	Maples with lots of Elbow Room, Year Round access and nice location between Cross River in Schroeder and Finland! MLS#6028422 \$53,000 REDUCED!	Heartland of Lutsen, 80 ac at the Foothill on Turnagain Trail, Fabulous Wilderness Build s of Ski Hill ridge, near downtown Lutsen! MLS#2312987 \$119,000	High Ridge Maples in Lutsen bordering public land. 44 ac of wild country, short distance to carry in access to Deeryard & Ward Lakes. Year round, power & fiber close. MLS#6078431 \$99,000 PENDING
Lakeshore on Ninemile Lake at the Village, common water and septic, build ready, borders common land! MLS#6076558 \$37,000	BIG TIME VIEWS of Lake Superior-Tofte, Excellent value at Johannes Toftey MLS#6029322 \$59,900	Over 8 ac of Wilderness on Turnagain Trail in Lutsen! MLS#2216560 \$45,000	NEW! 18 Maple Leaf, Hillside build site with lake views! MLS#6079411 \$49,000
SCHROEDER AND TOFTE AREAS	Overlook at LeVeaux Mountain-Tofte! Serene Woodsy setting with Lake Views! MLS#6029324 \$49,000	Build New in the Heart of Lutsen at Jonvick Creek! Hillside builds with some lakeviews! MLS#2240533 \$49,000	GRAND MARAIS AREA
NEW! Crosswinds in Tofte, Walk to Coho! Large pkg lots, Great Value. FROM \$45,000 MLS#6077966	Beaver Ponds, 40 acres, awesome wild life habitat in Schroeder/Finland area. MLS#6029593 \$99,000	Gorgeous 5 acre parcels in the Heart of Lutsen paved Caribou Trail locale bordering USFS lands! MLS#2174799 From \$54,900 - \$77,500	NEW! Cty 44 and Pike Lk Road! 10 acres of high level ground, easy build site at a great price! \$45,000 MLS#6076094
10 Ac Parcels of Maples! Rolling Terrain of Mature Maples to a Sweet Building site Parcels Over a Mixed Boreal Forest. Year Round Access and Electric at Road! MLS#2024250 \$49,900 REDUCED!	LeVeaux Creek Runs Through this Sweet Build Site, minutes to Lutsen Ski Resort! Lake Views! MLS#6031876 \$65,000 PENDING	30 acres of Prime Wilderness Land with year round access and electric at street with Views of Lutsen's famed Clara Lake! MLS#2080599 \$137,500	20 Acres near Pike Lake, minutes to the new Boat Landing! Driveway is in place, nice shed. Panoramic Wilderness! MLS#6028569 \$69,000 PENDING
DRAMATIC Mountain Top Views, Rolling Hills, Maple Forests fading in to Spruce and Pine and year round access. \$70,000 MLS#2090659 39 ACRES!	LUTSEN AREA	Jonvick Creek Runs Through It! Enjoy the Sounds of the Creek running by your future build site, Fabulous Lutsen Location just off the Caribou Trail! MLS#6074179 \$55,000	LAKE SUPERIOR views, Rolling terrain with creek meandering through the land. Beautiful setting less than five minutes to Grand Marais! MLS#6029849 \$65,000
Sawbill Trail Tofte Lake Superior Views, Mature Spruce forest with driveway and well in place! MLS#6030129 \$99,900	5 ac in the heart of Lutsen, just above TimberWolff! Great location for family home or Vaca Cabin! MLS#6077951 \$39,000	Tait Lake area, Legend Trail parcel bordering USFS lands with views of Wills and Williams Lake! MLS#6028619 \$67,500	Gorgeous 42 acres near Pike Lake, Yr Round access, electric at street and INCREDIBLE ridgetop views! MLS#6073655 \$109,900 PENDING
LeVeaux Mountain, Super Views and Wildlife Ponds! MLS#2220050 \$69,000	Caribou Hillside in Lutsen! Maple hillside above Ward Lake and Caribou Lake, FABULOUS location for summer and winter fun! Must see land! MLS#6078781 5 AC \$40,000	Wilderness Lutsen location at Tait Lake- backlot with Driveway in place! Yr Round and Electric MLS#6029115 \$33,000	
Just Up the Sawbill Trail Grab your little piece of the Northwoods, rolling terrain and small community	2 ac at the Foothills of Eagle Mountain at Turnagain Trail! \$29,900 MLS#6077521		

LAKE SUPERIOR LANDS

INLAND LAKE LANDS

NEW! NEARLY 8 ACRES AND 473 FT OF COBBLE BEACH SHORELINE ON LAKE SUPERIOR! Nice Build Sites, Rugged Terrain! Grand Portage area.
MLS#6078704 \$266,000 GREAT VALUE!

JUST NORTH OF SILVER BAY, PALISADE VIEWS OF LAKE SUPERIOR! Gorgeous Lakeshore, Priced Way Below Tax Assessed Value!
Gorgeous Views down the Coastline and Well buffered from Hwy. **MLS#2313255 \$198,000 REDUCED!**

SIMPLE LIVING ON LAKE SUPERIOR! A Step up from Thoreau's Cabin, Enjoy the peace and quiet this lovely little cabin offers on over 300 ft of Lake Superior Shoreline! Electric, and Nice gas Stove makes this a comfy and welcoming Cabin! **MLS#6026595 \$214,000 REDUCED!**

SCHROEDER, JUST OVER AN HOUR FROM DULUTH! Home site just 40 ft from the Big Lake, level easy access, well buffered from Hwy!
MLS#6032752 \$250,000

LARGE LAKE SUPERIOR PARCEL, JUST AN HOUR FROM DULUTH! Rolling terrain, level shoreline, and nearly 600 ft of it! Enjoy your own paradise on Lake Superior!
MLS#6032772 \$499,900

JUST IMAGINE, A MODERN NEW CONSTRUCTION BUNGALOW ON LUTSEN'S CASCADE BEACH RD! Gently sloping hillside buffers the build site from highway noise. Lovely setting with easy access to the ledge rock shoreline. Minute's to the Lutsen Mountains Ski & Summer Resort! Perfect for your Lake Superior getaway home! **MLS#2308906 \$299,000**



FISHERMAN'S DREAM GETAWAY, WALTER IS WAITING! End of the bay bordering USFS lands and some Super Shoreline! Call today for details!
MLS# 6027279 \$219,000

RUSTIC GETAWAY LAKESHORE, ISABELLA AREA. Mature pines, end of the road location on Swallow Lake! **MLS#2300576 \$64,900**

LUTSEN LAKESHORE ON DEERYARD! Year Round access, elec/broadband. Maple hillside, Rocky prime shoreline!
MLS#6074179 \$185,000 REDUCED!

Owner is licensed REALTOR
CLARA LAKE IN LUTSEN! Wilderness Lakeshore Site with cleared build site, driveway in place. Electric at road, 200 ft PRIME shoreline.
\$189,900 MLS#6033095

CHRISTINE LAKE 10 AC bordering Superior National Forest, Yr Round Access, electric/ broadband avail. Hill top build site overlooking mature white pine, cedar lined shoreline on Christine. Serenity Now!
MLS#6023288 \$99,900

PIKE LAKE LUTSEN SIDE! Premium Shoreline, nice and rocky! South facing build site, boreal forest. Lot 6 Willard Lane, must see! **MLS#6031145 \$190,000 REDUCED!**

NEW! WILLARD LANE PIKE LAKE VIEW LAND WITH LAKE ACCESS! Rugged elevation, great build site. Shared 20 ft access to Pike Lake for **\$75,000 MLS#6078799**



VISIT US AT WWW.TIMBERWOLFFREALTY.COM FOR PICTURE SLIDESHOW!

Own a slice of Minnesota's Favorite Resorts
We bring you closer. To the lake, each other and
your vacation property dreams.

Bluefin Bay Condos & Townhomes



Bluefin Unit 7
3 BR, 2 BA. Recent \$130K
elegant remodel. Only
a few feet from shore.
\$419,900



Bluefin Unit 18
2 BR, 2 BA floorplan.
Unique to the whole
resort. A guest favorite.
\$340,000



Bluefin Unit 26
1 BR/1 BA. Ideal location.
Exceptional value and solid
investment at reasonable
price. **\$259,900**



Bluefin Unit 32
1 BR, 1 BA. Charming
unit with brand new
bath, kitchen, and
fireplace. \$50K in Rental
Income. **\$275,000**



Bluefin Unit 37
2 BR, 2 BA. Upper level
unit affords panoramic
lake views. Over \$60K in
rental income. **\$315,000**



Bluefin Unit 38
2 BR, BA turn-key
rental property. Newly
remodeled and tastefully
decorated. **\$319,000**



Bluefin Unit 55
3 BR and 3 BA.
Beautiful upgrades and
appointments. Great
location near outdoor
pool. **\$569,000**



Bluefin Unit 61
3 BR, 3 BA Bluefin's
largest town home.
Grosses over \$110K in
rental income. Absolutely
stunning. **\$564,000**

Surfside on Lake Superior



New townhomes, total coastal luxury right on the shore of Lake Superior. 3,000 s/f, 3BR, 3BA. Quarter-share ownership w/ flexibility for personal use & rental income. Excellent family retreat or investment property. Prices from \$174K-\$215K, includes furnishings.



Eric Frost

Sales Agent, Bluefin Bay Family of Resorts

Let Eric, exclusive sales agent for Bluefin Bay Family of Resorts, provide the details about each property and guide you through the process. Contact him today to learn more.



218-663-6886 | eric@bluefinbay.com



Bluefin Bay | Surfside | Temperance Landing *On the shores of Lake Superior in Tofte, Minnesota*



Deb Niemisto
218-370-8434



Nan Bradley
218-370-8433

lockport@boreal.org



www.coldwellbankernorthwoods.com

LAKE SUPERIOR CONDOS
Chateau 1 BD 1 BA Turn-Key Rented Units



Newly remodeled log lodge cabin like condo with spectacular lake views.
MLS 6077019 \$79,900



Upgraded cottage themed condo. Great rental income!
MLS 6077201 \$69,900

7072 Two Moose Trail
Wilson Lake - Finland



Experience Solitude on one of the most beautiful lakes around. Acreage with many amenities ready for use & enjoyment. **MLS 608329 \$246,900**

Caribou Lake - Lutsen
38 Sawmill Lane

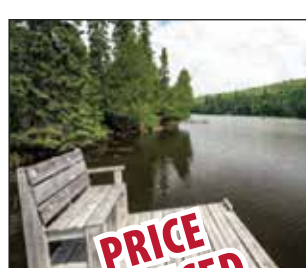

WOW 4 BD, 2 BA custom built home on Lutsen's #1 premier lake. Gazebo, dock, fire pit, large family room, open concept one level living.
MLS 6074363 \$497,000

Commercial -
126 Airport Rd
Grand Marais Airport



Commercial hangar, heated, insulated, rental income
MLS 2116969 \$275,000

Lake Superior - Lutsen
19 Norwood Shores East



3 BD, 3 BA Townhome, open Concept, Fireplace, garage
MLS 6078350 \$369,000